

LINEAR HARSH SERIES

LED LIGHTING FOR HARSH INDUSTRIAL ENVIRONMENTS

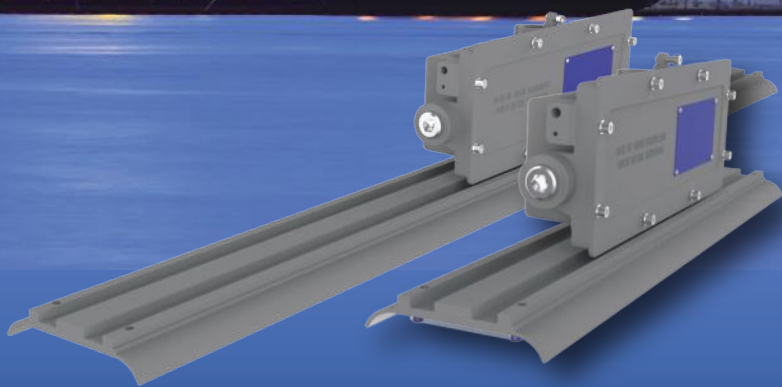

Reliable. Durable. Efficient.
4,100 to 12,000 lumen models

RED SKY
SERIOUSLY SAFE LIGHTS™

ABOUT RED SKY LIGHTING

PIONEERING INDUSTRIAL ILLUMINATION FOR HARSH & HAZARDOUS CONDITIONS

- A leading manufacturer of premium LED lights for demanding work conditions
- Headquartered in California, products assembled in the USA
- Servicing global clients across 4 continents in metal processing, oil & gas, marine, manufacturing
- Renowned for quality, dependability, client care and uncompromising safety standards



WHY CHOOSE RED SKY

⚡ SERIOUSLY SAFE LIGHTS

- Rigorously tested in our professional labs
- Surpassing industry certifications and safety protocols
- Crafted with highest grade components for maximum durability

⚡ TOP-NOTCH SERVICES

- Team of experts for seamless support
- Energy audit services and lighting simulation services
- Hassle-free return policy and management

⚡ FAST DELIVERY

- Majority of orders delivered within 14 days
- Same day shipping for products in stock
- Real-time order tracking for full transparency

⚡ SUSTAINABLE SOLUTIONS

- High luminous efficacy LEDs for energy savings
- Conscious product design
- Recyclable materials for products and packaging

LINEAR HARSH SERIES



With its rugged copper-free aluminum construction, the Linear Harsh Series is built to perform in the most demanding industrial environments. Designed for durability, it withstands high temperatures, vibration, moisture, and dust—delivering long-lasting performance in corrosive or wet settings such as coastal facilities, processing plants, and utility areas.

Featuring a maintenance-free design, the Linear Harsh Series delivers over 147,000 hours of consistent light output at temperatures up to 149°F (65°C), and operates reliably in extreme cold down to -40°F (-40°C). Its 1-10V dimmable driver and high luminous efficacy of up to 151 lumens per watt help reduce energy costs while maintaining high-quality illumination.

Installation is streamlined with a built-in wiring compartment featuring three ¾" NPT conduit entries and WAGO connectors. The Linear Harsh Series supports multiple mounting methods including suspended, wall, or surface configurations. An optional retrofit bracket allows for quick replacement of existing fixtures.

Backed by Red Sky Lighting's 10-year warranty, the Linear Harsh Series offers a durable, energy-efficient lighting solution built for harsh industrial applications.

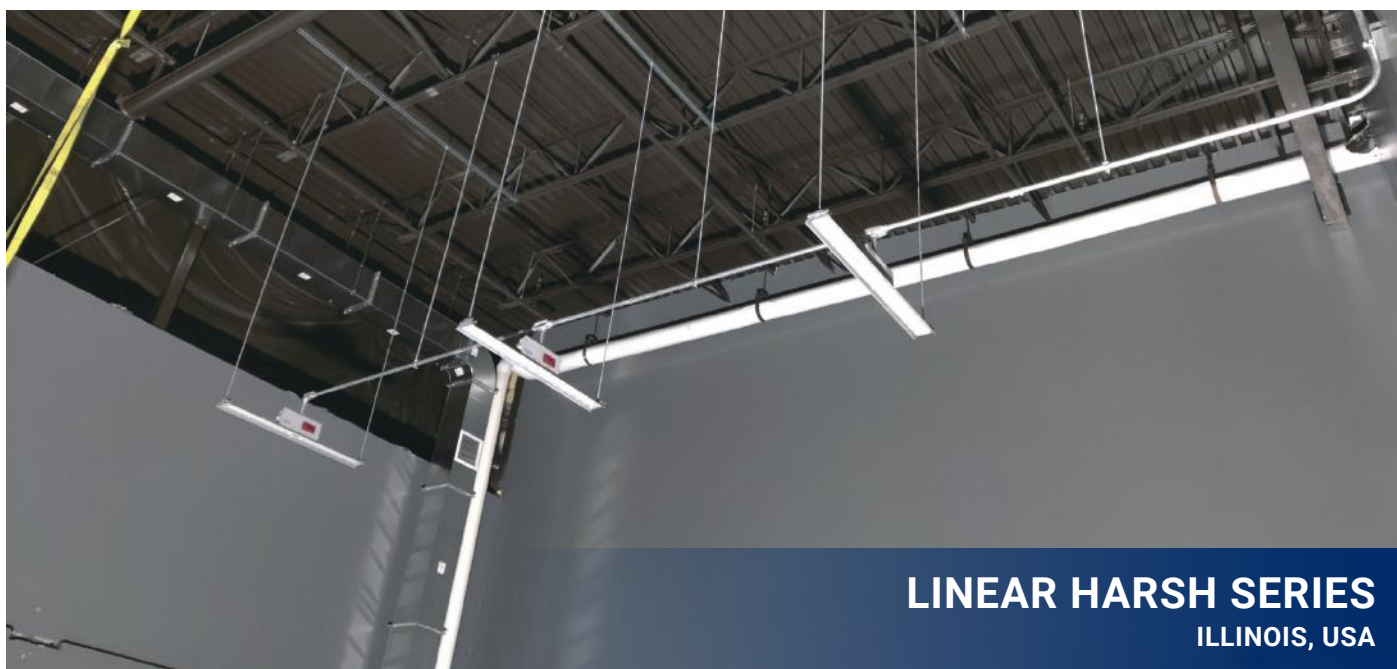

LINEAR HARSH SERIES

ILLINOIS, USA

FEATURES



▮ Rugged Construction

Built to withstand extreme temperatures, vibration, water and dust. Copper-free aluminum body and frame for corrosion-resistant

▮ Easy and Through Wiring

Built-in wiring compartment with three NPT 3/4" entries and WAGO 221 lever connectors for easy wiring

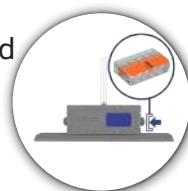

▮ Multiple Mounting Options

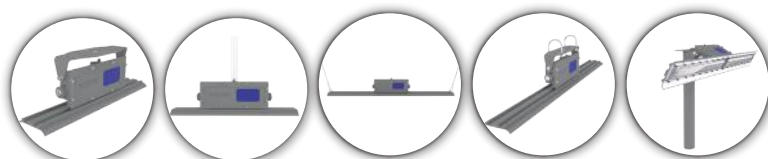

▮ Long Fixture Life

L70 >147,000 Hours@149°F
Maintenance-free and safe operation

RATINGS

UL 1598 Wet Locations
UL 1598A Marine Outside Type (Salt Water)
IP66
IK08
Salt Spray 720 hrs (ASTM B117)
NEMA 4X

CERTIFICATIONS

UL 1598
UL 1598A
CSA C22.2 NO. 250.0
DLC Standard*
FCC Part 15, Subpart B

* Not all product variations listed on this page are DLC qualified. Visit www.designlights.org/search to confirm qualification.
DLC available with CRI 80 models only.

TECHNICAL PARAMETERS

| Specification | LNR2-30 | LNR2-40 | LNR2-60 | LNR2-80 |
|------------------------------------|---------------------------------------|---------|--------------------------------|----------|
| Electrical Parameters | | | | |
| Power | 30W | 40W | 60W | 80W |
| Rated Input Current(120V AC) | 0.277A | 0.370A | 0.555A | 0.740A |
| Rated Input Current(277V AC) | 0.120A | 0.160A | 0.240A | 0.320A |
| Rated Input Current(347V AC) | / | 0.128A | 0.192A | 0.256A |
| Rated Input Current(480V AC) | / | 0.092A | 0.138A | 0.185A |
| Voltage/Frequency | 100-277V AC, 347-480V AC 50/60Hz | | | |
| Power Factor | ≥0.90 | | | |
| THD | <20% | | | |
| L70 | 147,000 hrs@149°F | | | |
| Dimming* | 0-10V, Range 10-100% | | | |
| Surge Protection | 10KV | | | |
| Supply Wire | 12-18AWG , Rated 90°C | | | |
| Warranty | LEDs: 10 years, Driver: 7 years | | | |
| Optical Parameters | | | | |
| Lumen Output** | 4,142Lm | 5,403Lm | 8,802Lm | 11,536Lm |
| Lumen Efficacy** | 151Lm/W | | | |
| Correlated Color Temperature (CCT) | 3000K/4000K/5000K | | | |
| Color Rendering Index (CRI) | 80 CRI | | | |
| Mechanical Parameters | | | | |
| Housing Material | Copper-free (< 0.4%) aluminum | | | |
| Hardware | Stainless steel 316 | | | |
| Lens Material | Polycarbonate | | | |
| Mounting Options | Pendant, Yoke, Chain, Pole, Stanchion | | | |
| Product Weight | 11.0lbs/5.0kg | | 14.68lbs/6.66kg | |
| Package Weight | 13.1lbs/6.0kg | | 16.78lbs/7.66kg | |
| Cable Entry | (3) 3/4" NPT | | | |
| Product Dimensions(L×W×H) | 23.6×5.0×6.6in(600×127×168mm) | | 47.2×5.0×6.6in(1200×127×168mm) | |
| Package Dimensions(L×W×H) | 26.4×5.9×7.9in(670×150×200mm) | | 50.4×6.3×8.3in(1280×160×210mm) | |
| Environmental Parameters | | | | |
| Ambient Operating Temperature | -40°F ~ 149°F (-40°C ~ 65°C) | | | |
| EPA wind rating (FT2) | 1.463(Yoke), 1.448(Stanchion) | | 1.972(Yoke), 1.957(Stanchion) | |

* LNR2-40-347-480V Dimming Unavailable

** Value calculated based on 5000K,80 CRI and Clear PC, varies to different spec.
70 CRI & 90 CRI optional, DLC available with 80 CRI only.

ORDERING INFORMATION

EXAMPLE: LNR2-40-100-277-5K-CP-GRY-PND

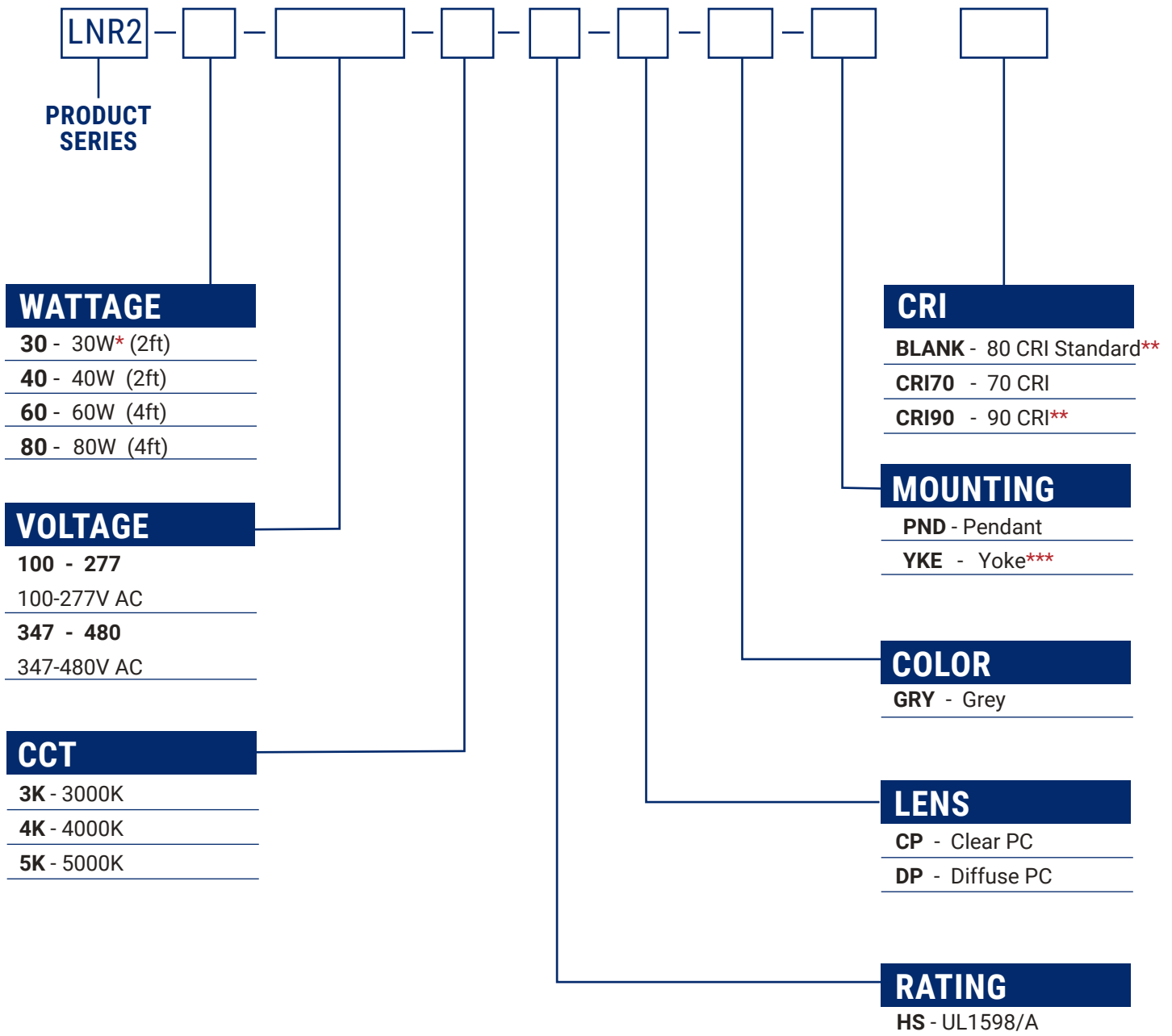

* Unavailable in 347-480V AC

** CRI90 expects longer leadtime

** DLC available with 80 CRI only. Not all product variations listed on this page are DLC qualified. Visit www.designlights.org/search to confirm qualification.

*** LNR-YOKE Pre-installed

MOUNTING ACCESSORIES



Pendant

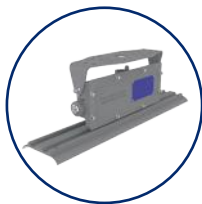

Yoke

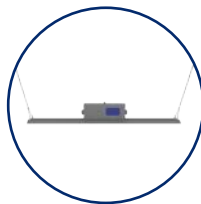

Chain

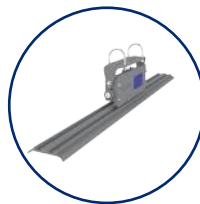

Pipe clamp



Stanchion

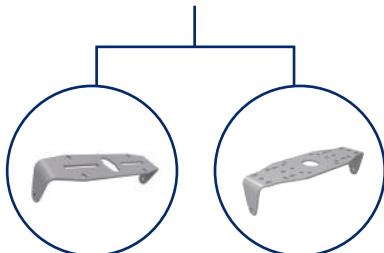

LNR-YOKE

LNR-YOKE P

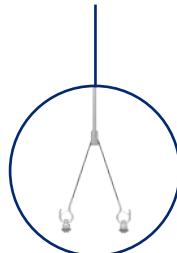

CHAIN01



CLAMP01/02



STAN01

| Mounting Method | PN | Description | MPN Code |
|-----------------|-------------|--|-----------|
| Yoke | LNR-YOKE | Yoke Mount, SUS304, Powder-Coated Grey RAL 7037 | 309050042 |
| | LNR-YOKE P* | Yoke Plus Mount, SUS304, Powder-Coated Grey RAL 7037 | 309050332 |
| Chain | CHAIN01 | Chain Hang Kit, SUS304 | 309050071 |
| Pipe clamp | CLAMP01** | Pipe Clamp Kit for Round Pole 1-7/8 inch OD (48 mm), SUS304 | 309050047 |
| | CLAMP02** | Pipe Clamp Kit for Round Pole 2-3/8 inch OD (60 mm), SUS304 | 309050046 |
| Stanchion | STAN01** | Slip-Fit Stanchion Mount Kit for 2 inch Diameter (2-3/8 inch OD, 60mm OD) Poles, Non-Threaded, SUS304, Powder-Coated Grey RAL 7037 | 309050300 |

* Retrofit Bracket Compatibility Chart

For customers trying to retrofit an existing fixture, use the table below as a guide to select the best bracket to suit your need

| Manufacturer | Part Number | Retrofit Yoke |
|------------------|-------------|---------------|
| Crouse Hinds | DP057MTK | ✓ |
| Dialight | LTXW4 | ✓ |
| | LTXW4LP | ✓ |
| AZZ™ Rig-A-Lite™ | 53050 | ✓ |
| Appleton | RMLSB | ✓ |

** Requires A Yoke Mount

OTHER ACCESSORIES



SFCB03

| PN | Description | MPN Code |
|---------|--|-----------|
| SFCB03 | Safety Cable Kit, SUS304 | 309050049 |
| GLCO-03 | 3 ft Cord (SOOW 14 AWG × 3, 105 degrees Celsius, 600V) with Cable Gland | 204020003 |
| GLCO-10 | 10 ft Cord (SOOW 14 AWG × 3, 105 degrees Celsius, 600V) with Cable Gland | 204020004 |

SLIP-FIT JUNCTION BOX

The **Junction Box** is a multi-piece assembly featuring a copper-free, cast-aluminum housing, front cover, and cable gland. The design accommodates both stanchion installation and other mounting options. It is compatible with 2" (2 3/8" OD) and 1.5" (1.9" OD) poles, both NPT-threaded and non-threaded.

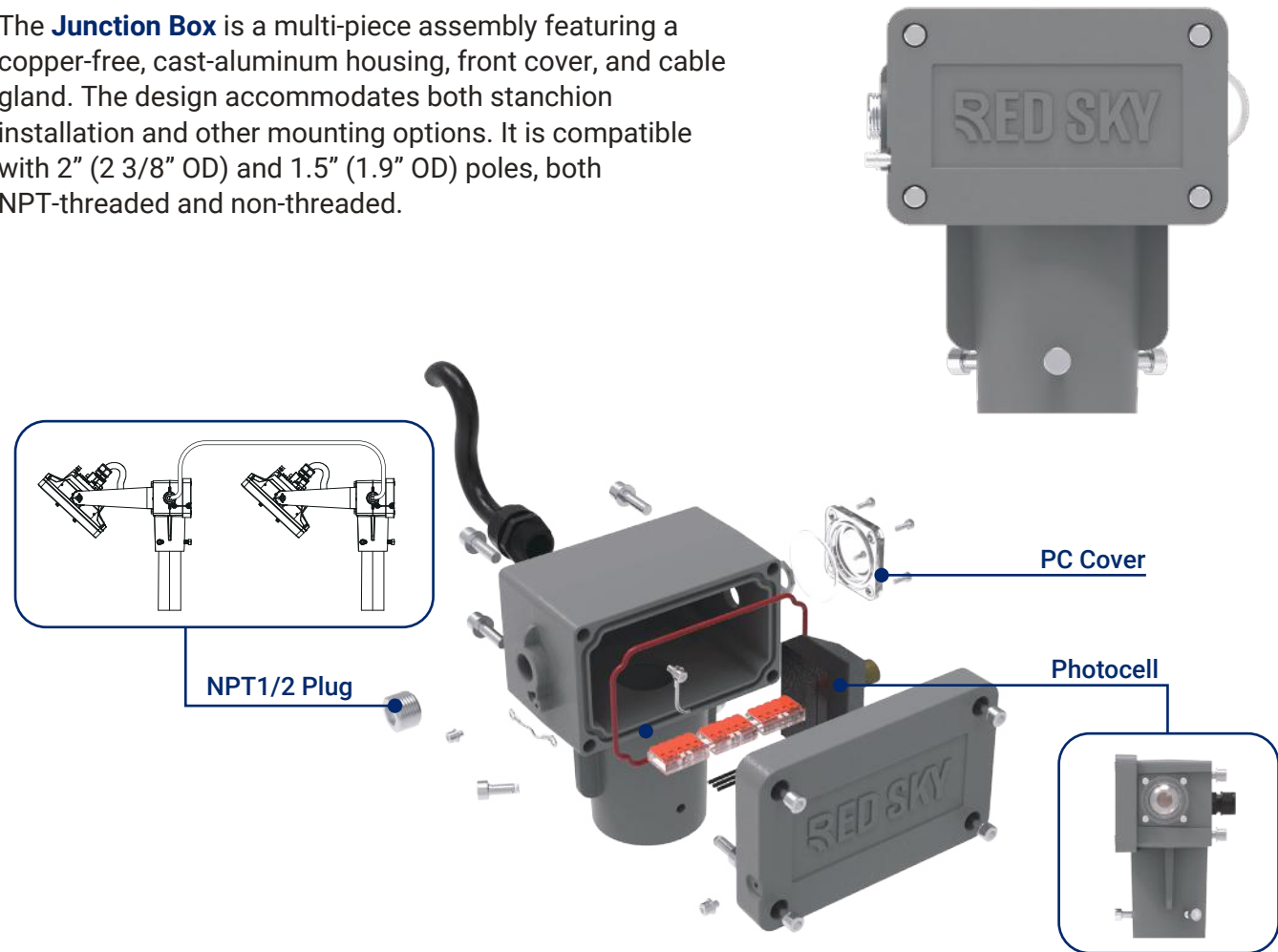

FEATURES

- Weather-resistant finish suitable for wet locations and marine environments
- WAGO 211 lever connectors (5-pole, UL/CSA, 18-12 AWG) for easy, hassle-free wiring
- Wiring access cover with captive screws and a rear hub featuring NPT 1/2" threads for daisy-chain wiring
- Shock and vibration-resistant design

CERTIFICATIONS & RATINGS

UL1598
UL1598A
CSA C22.2 NO. 250.0
UL 1598 Wet Locations
UL 1598A Marine Outside Type (Salt Water)
IP66
IK10
Salt Spray 720 hrs (ASTM B117)

SLIP-FIT JUNCTION BOX

INSTALLATION EXAMPLE

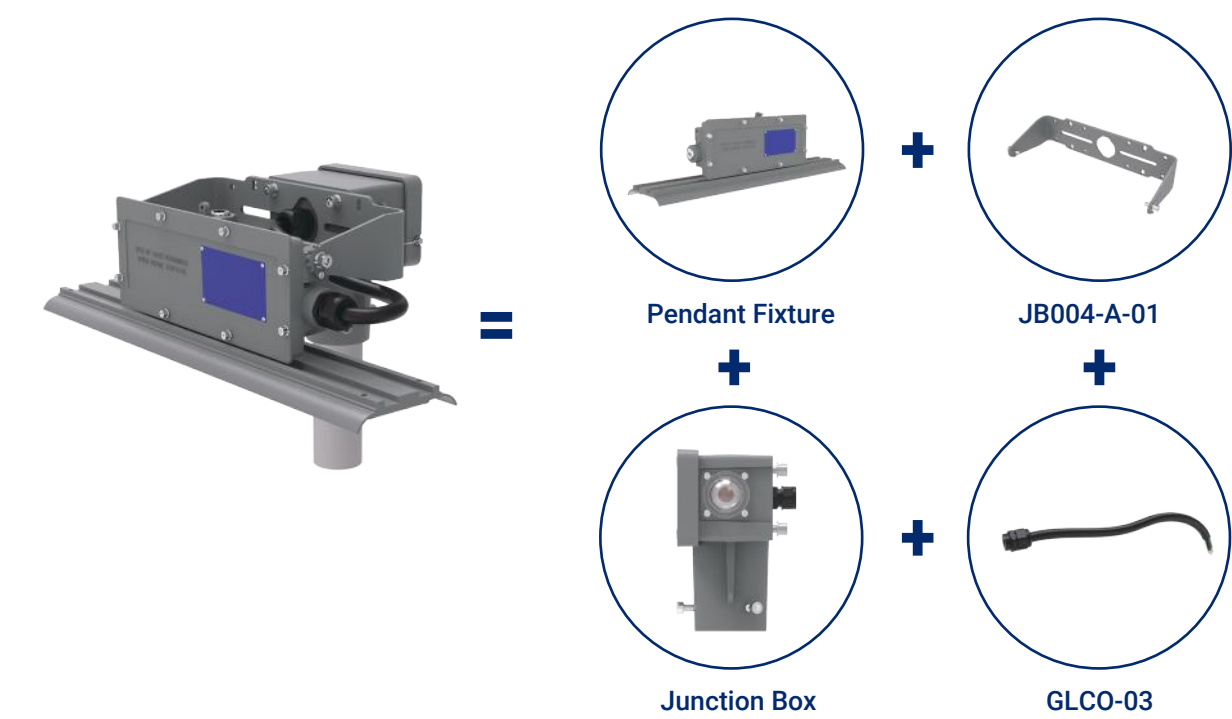

ORDERING INFORMATION

| Part Number | Description | MPN Code |
|-------------|--|-----------|
| JB01 | 1.5 inch (1.9 inch OD) and 2 inch (2-3/8 inch OD) NPT Threaded Slip-Fit Junction Box | 309050379 |
| JB02-P | 1.5 inch (1.9 inch OD) and 2 inch (2-3/8 inch OD) NPT Threaded Slip-Fit Junction Box + Sensor (120V) | 309050380 |
| JB03-P | 1.5 inch (1.9 inch OD) and 2 inch (2-3/8 inch OD) NPT Threaded Slip-Fit Junction Box + Sensor (208-277V) | 309050381 |
| JB04 | 1.5 inch (1.9 inch OD) and 2 inch (2-3/8 inch OD) Non-Threaded Slip-Fit Junction Box | 309050382 |
| JB05-P | 1.5 inch (1.9 inch OD) and 2 inch (2-3/8 inch OD) Non-Threaded Slip-Fit Junction Box + Sensor (120V) | 309050383 |
| JB06-P | 1.5 inch (1.9 inch OD) and 2 inch (2-3/8 inch OD) Non-Threaded Slip-Fit Junction Box + Sensor (208-277V) | 309050384 |
| JB013-A-01 | BLK2 Custom Bracket Assembly | 309050388 |
| GLCO-03 | 3 ft Cord (SOOW 14 AWG × 3, 105 degrees Celsius, 600V) with Cable Gland | 204020003 |

REPLACEMENT PARTS (ORDERED SEPARATELY)

| Part Number | Description | MPN Code |
|------------------------|--|-----------|
| LNR2-30-100-277-Driver | Replacement Driver Kit for LNR2-30-100-277 Fixtures | 303010042 |
| LNR2-40-100-277-Driver | Replacement Driver Kit for LNR2-40-100-277 Fixtures | 303010043 |
| LNR2-60-100-277-Driver | Replacement Driver Kit for LNR2-60-100-277 Fixtures | 303010044 |
| LNR2-80-100-277-Driver | Replacement Driver Kit for LNR2-80-100-277 Fixtures | 303010045 |
| LNR2-40-347-480-Driver | Replacement Driver Kit for LNR2-40-347-480 Fixtures | 303010046 |
| LNR2-60-347-480-Driver | Replacement Driver Kit for LNR2-60-347-480 Fixtures | 303010047 |
| LNR2-80-347-480-Driver | Replacement Driver Kit for LNR2-80-347-480 Fixtures | 303010048 |
| CP004-A-01 | Replacement Clear PC Lens for LNR2, LNR EM, LLP, LNH | 303030012 |
| DP004-A-01 | Replacement Diffuse PC Lens for LNR2, LNR EM, LLP, LNH | 303030013 |

| PN | Wattage (W) | CCT | CRI | Beam | Lens | Lumen Output (Lm) | Efficiency (Lm/W) |
|----|-------------|-----|-----|------|------|-------------------|-------------------|
|----|-------------|-----|-----|------|------|-------------------|-------------------|

Voltage 100-277VAC 80 CRI • STANDARD

| | | | | | | | |
|----------------------------------|----|-------|----|------|------------|--------|-----|
| LNR2-30-100-277-5K-HS-CP-GRY-YKE | 30 | 5000K | 80 | 110° | Clear PC | 4,142 | 143 |
| LNR2-30-100-277-5K-HS-DP-GRY-YKE | 30 | 5000K | 80 | 110° | Diffuse PC | 3,736 | 129 |
| LNR2-40-100-277-5K-HS-CP-GRY-YKE | 40 | 5000K | 80 | 110° | Clear PC | 5,403 | 141 |
| LNR2-40-100-277-5K-HS-DP-GRY-YKE | 40 | 5000K | 80 | 110° | Diffuse PC | 4,864 | 127 |
| LNR2-60-100-277-5K-HS-CP-GRY-YKE | 60 | 5000K | 80 | 110° | Clear PC | 8,802 | 151 |
| LNR2-60-100-277-5K-HS-DP-GRY-YKE | 60 | 5000K | 80 | 110° | Diffuse PC | 8,195 | 136 |
| LNR2-80-100-277-5K-HS-CP-GRY-YKE | 80 | 5000K | 80 | 110° | Clear PC | 11,536 | 146 |
| LNR2-80-100-277-5K-HS-DP-GRY-YKE | 80 | 5000K | 80 | 110° | Diffuse PC | 10,600 | 132 |

Voltage 100-277VAC 70 CRI

| | | | | | | | |
|---------------------------------------|----|-------|----|------|------------|--------|-----|
| LNR-30-100-277-5K-HS-CP-GRY-YKE CRI70 | 30 | 5000K | 70 | 110° | Clear PC | 4,426 | 152 |
| LNR-30-100-277-5K-HS-DP-GRY-YKE CRI70 | 30 | 5000K | 70 | 110° | Diffuse PC | 3,949 | 136 |
| LNR-40-100-277-5K-HS-CP-GRY-YKE CRI70 | 40 | 5000K | 70 | 110° | Clear PC | 5,795 | 151 |
| LNR-40-100-277-5K-HS-DP-GRY-YKE CRI70 | 40 | 5000K | 70 | 110° | Diffuse PC | 5,171 | 135 |
| LNR-60-100-277-5K-HS-CP-GRY-YKE CRI70 | 60 | 5000K | 70 | 110° | Clear PC | 9,185 | 158 |
| LNR-60-100-277-5K-HS-DP-GRY-YKE CRI70 | 60 | 5000K | 70 | 110° | Diffuse PC | 8,256 | 143 |
| LNR-80-100-277-5K-HS-CP-GRY-YKE CRI70 | 80 | 5000K | 70 | 110° | Clear PC | 12,026 | 155 |
| LNR-80-100-277-5K-HS-DP-GRY-YKE CRI70 | 80 | 5000K | 70 | 110° | Diffuse PC | 10,785 | 139 |

Voltage 100-277VAC 90 CRI

| | | | | | | | |
|---------------------------------------|----|-------|----|------|------------|--------|-----|
| LNR-30-100-277-5K-HS-CP-GRY-YKE CRI90 | 30 | 5000K | 90 | 110° | Clear PC | 3,767 | 129 |
| LNR-30-100-277-5K-HS-DP-GRY-YKE CRI90 | 30 | 5000K | 90 | 110° | Diffuse PC | 3,361 | 116 |
| LNR-40-100-277-5K-HS-CP-GRY-YKE CRI90 | 40 | 5000K | 90 | 110° | Clear PC | 4,932 | 129 |
| LNR-40-100-277-5K-HS-DP-GRY-YKE CRI90 | 40 | 5000K | 90 | 110° | Diffuse PC | 4,401 | 115 |
| LNR-60-100-277-5K-HS-CP-GRY-YKE CRI90 | 60 | 5000K | 90 | 110° | Clear PC | 7,816 | 134 |
| LNR-60-100-277-5K-HS-DP-GRY-YKE CRI90 | 60 | 5000K | 90 | 110° | Diffuse PC | 7,026 | 122 |
| LNR-80-100-277-5K-HS-CP-GRY-YKE CRI90 | 80 | 5000K | 90 | 110° | Clear PC | 10,234 | 132 |
| LNR-80-100-277-5K-HS-DP-GRY-YKE CRI90 | 80 | 5000K | 90 | 110° | Diffuse PC | 9,178 | 118 |

347–480Vac models deliver the same lumen output as the 100–277Vac models.

This table lists only selected lumen packages. For additional model parameters, please contact our sales team.

Note: LXX# = nominal lumens. Verify lumen package before ordering.

LUMEN MAINTENANCE

| Ambient \ Hours | 0 | 15,000 | 30,000 | 45,000 | 60,000 | 75,000 | 90,000 | 100,000 | 150,000 |
|-----------------|------|--------|--------|--------|--------|--------|--------|---------|---------|
| 25°C | 100% | 98% | 95% | 92% | 89% | 87% | 84% | 82% | 74% |
| 35°C | 100% | 98% | 95% | 92% | 89% | 87% | 84% | 82% | 74% |
| 45°C | 100% | 97% | 95% | 92% | 89% | 86% | 83% | 82% | 73% |
| 55°C | 100% | 97% | 94% | 91% | 88% | 85% | 82% | 81% | 72% |
| 65°C | 100% | 97% | 94% | 91% | 87% | 84% | 81% | 79% | 71% |

LUMINAIRE LIFESPAN

| Ambient Temperature | Luminaire Lifespan (Hours) | Rated Service Life - Years (24/7 Operation) | Rated Service Life - Years (12/7 Operation) |
|---------------------|----------------------------|---|---|
| 25°C (+77°F) | 100,000 | 11 | 23 |
| 35°C (+95°F) | 100,000 | 11 | 23 |
| 45°C (+113°F) | 100,000 | 11 | 23 |
| 55°C (+131°F) | 90,000 | 10 | 21 |
| 65°C (+149°F) | 72,000 | 8 | 16 |

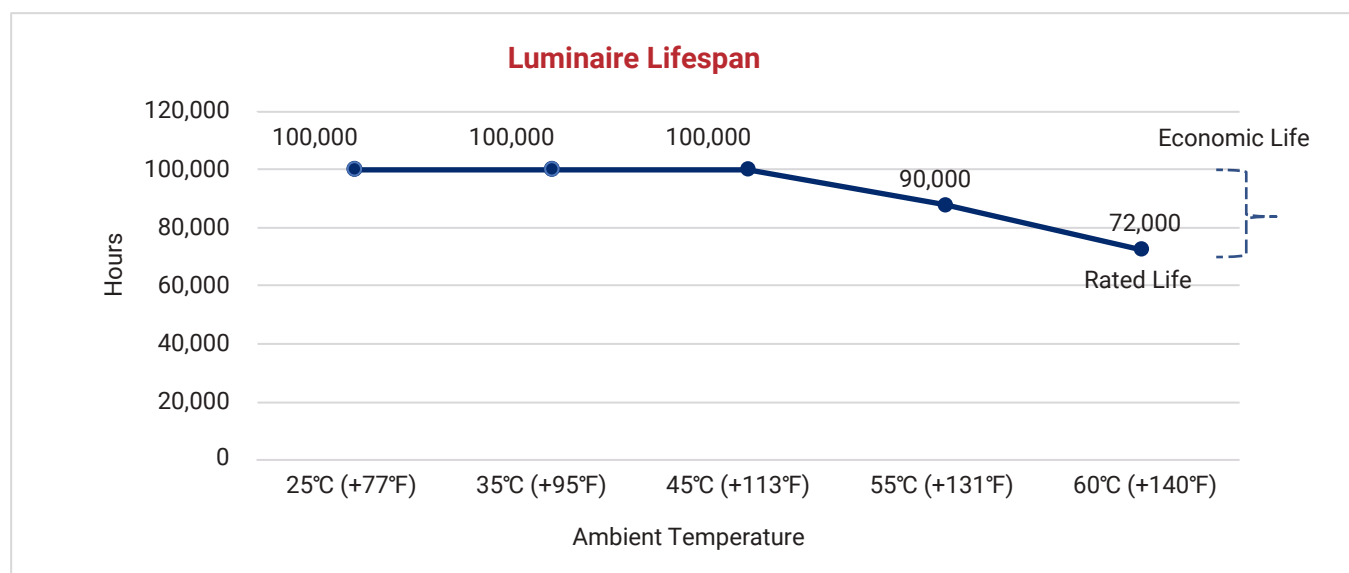

Information shown for reference only and may vary by configuration.

A DIRECT RETROFIT FROM HID TO LED

The LNR series LED is easy to retrofit in the same configuration as your existing HID luminaires. For example, a 80-watt Linear (LNR2-80) delivers virtually the same illumination as its equivalent 250 watt Metal Halide luminaire while providing 80% reduction in energy costs and up to 147,000 hours of continuous operation.







| MODELS | Lumen Output (Lm) | MH Equivalent (W) | HPS Equivalent (W) |
|---------|-------------------|-------------------|--------------------|
| LNR2-30 | 4,142 | 100 | 100 |
| LNR2-40 | 5,403 | 150 | 150 |
| LNR2-60 | 8,802 | 200 | 250 |
| LNR2-80 | 11,536 | 250 | 310 |

THE RIGHT BEAM PATTERN FOR YOUR APPLICATION

RSL optic package is engineered to deliver maximum footcandles efficiently where you need them, without wasted light or overspill.

RSL offers complimentary lighting design services for our products using industry-leading AGI32 software, tailored for projects of all sizes in harsh and hazardous locations. We assist you in determining the number of fixtures needed, the types of lights to use, their optimal placement, and how to maximize energy savings—all within budget.

Simply fill out the form (<https://www.redskylighting.com/lighting-design>) with a few key details, request a layout, and we'll bring your ideas to life within 2-5 business days.

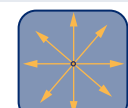
| Beam | NEMA/IESNA Type | Beam Description | Beam Projection Distance |
|------|---------------------------|---|---|
| 30° | NEMA 3 | Medium Narrow |  |
| 60° | NEMA 4 | Medium |  |
| 90° | NEMA 5 | Medium Wide |  |
| 120° | NEMA 6 | Wide |  |
| T1 | Type I | Asymmetric distributions, well suited for narrow areas, such as Conveyor belts, Aisleways, Catwalks, Loading docks and Tunnels. |  |
| T2 | Type II | Asymmetric distributions, well suited for narrow areas, such as roadways, paths and driveways. |  |
| T3 | Type III | Asymmetric distributions, well suited for site / area perimeters, wide roadways, and open areas. |  |
| T5 | NEMA 7 Type V (Square) | Very Wide: symmetrical pattern with excellent uniformity for large, open areas. |  |

unit: in (mm)

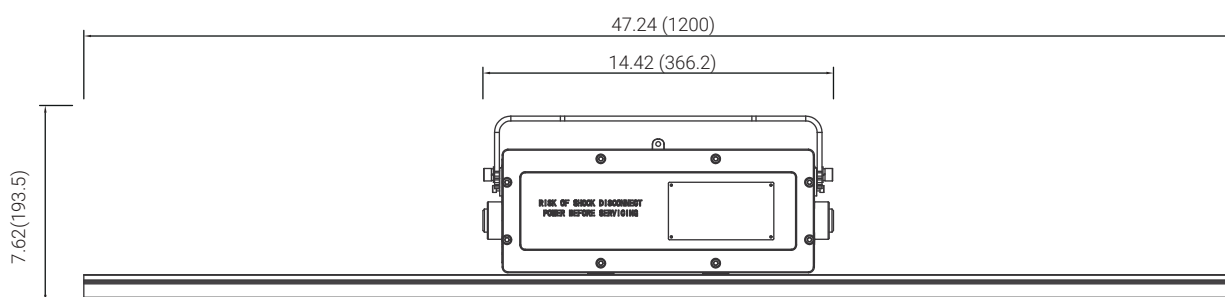
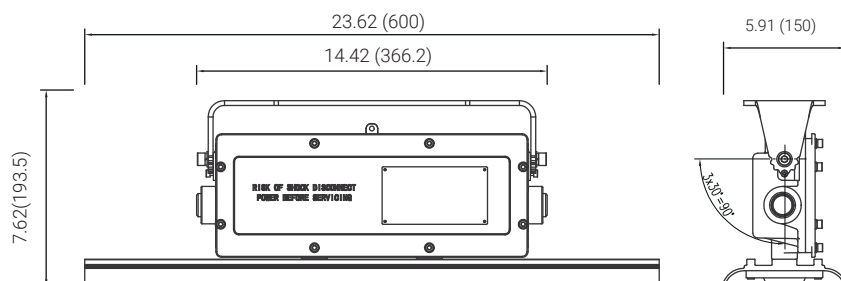

Yoke

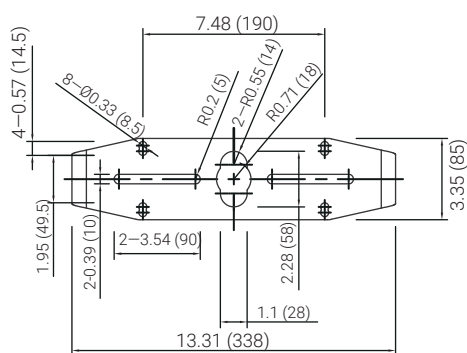

LNR-YOKE

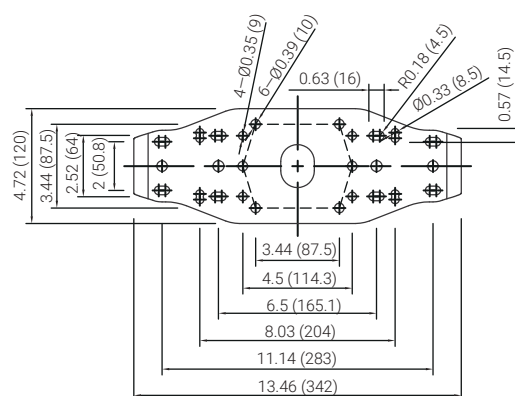

LNR-YOKE P

unit: in (mm)

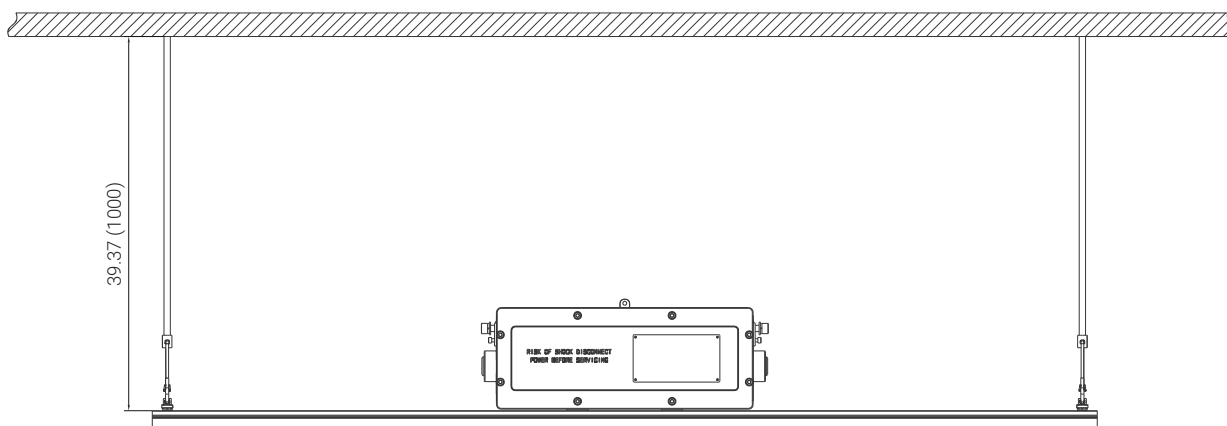

Chain

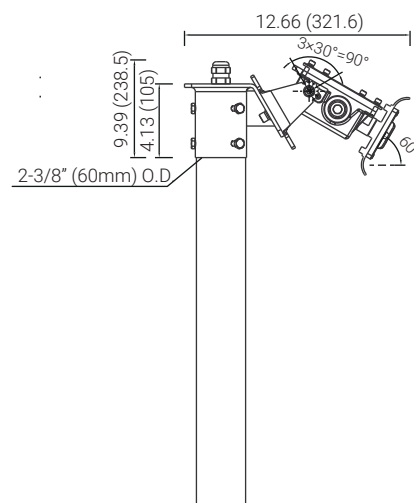
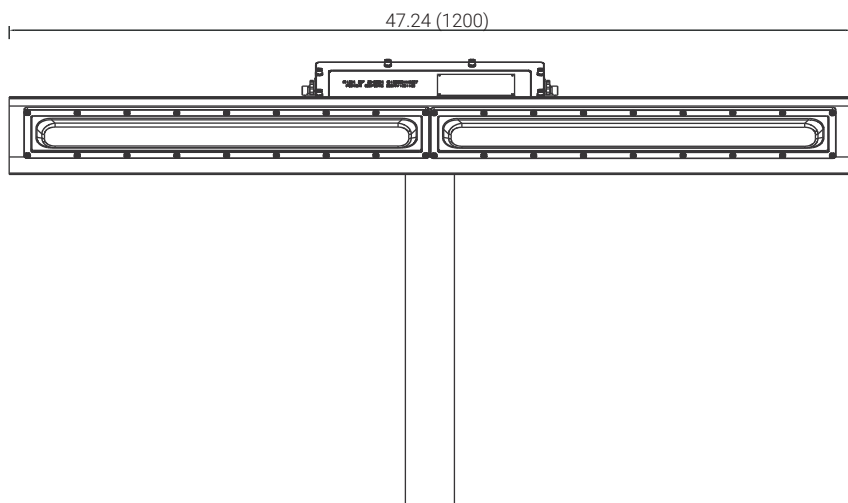

Stanchion

unit: in (mm)

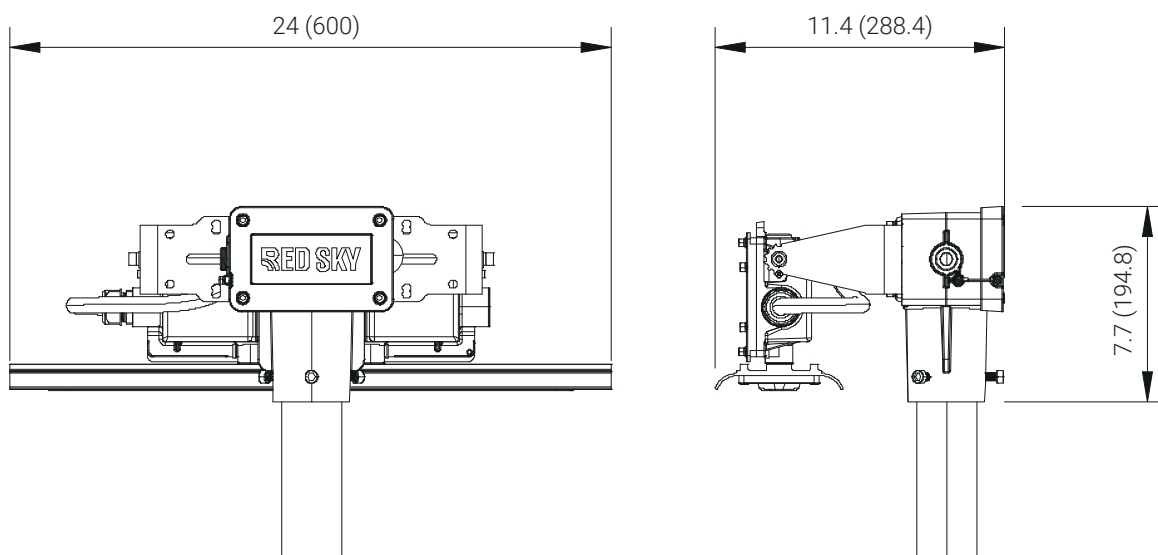
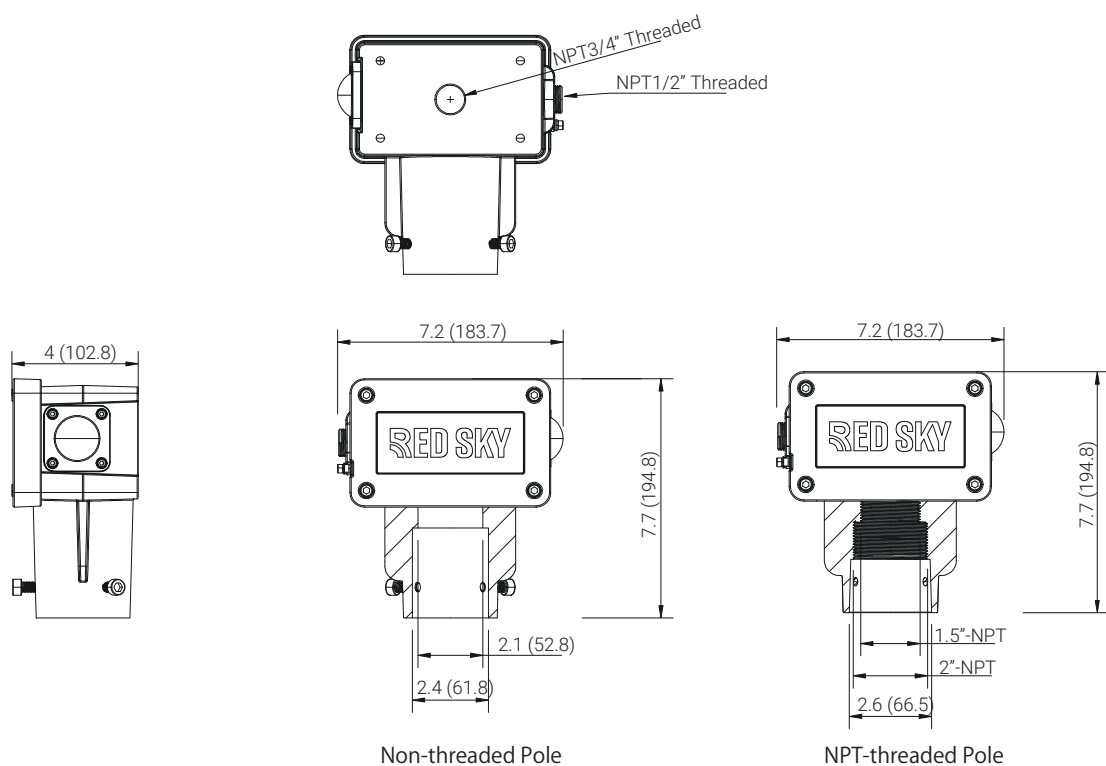

Slip-fit Junction Box

Let's light your next project—
Email us at **contact@redskylighting.com**,
call us at **1 (262) 456-5002**
or visit **www.redskylighting.com** to get started.

Disclaimer

All product information is subject to change without notice.
Please contact Red Sky Lighting or your sales representative for the most up-to-date specifications.