

LINEAR LOW PROFILE SERIES

HAZARDOUS LOCATION LED LUMINAIRE



Reliable. Durable. Efficient.
2,200 to 9,400 lumen models



RED SKY
SERIOUSLY SAFE LIGHTS™

PIONEERING INDUSTRIAL ILLUMINATION FOR HARSH & HAZARDOUS CONDITIONS

A leading manufacturer of premium LED lights for demanding work conditions

Headquartered in California, products assembled in the USA

Servicing global clients across 4 continents in metal processing, oil & gas, marine, manufacturing

Renowned for quality, dependability, client care and uncompromising safety standards

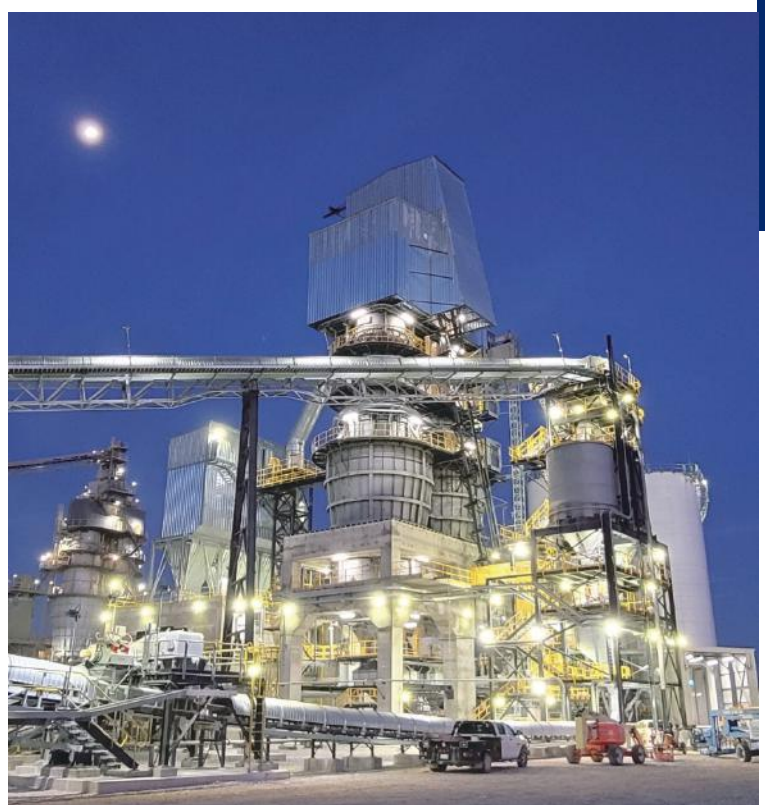

WHY CHOOSE RED SKY

SERIOUSLY SAFE LIGHTS

- Rigorously tested in our professional labs
- Surpassing industry certifications and safety protocols
- Crafted with highest grade components for maximum durability

TOP-NOTCH SERVICES

- Team of experts for seamless support
- Energy audit services, lighting simulation services
- Hassle-free return policy and management

FAST DELIVERY

- Majority of orders delivered within 14 days
- Same day shipping for products in stock
- Real-time order tracking for full transparency

SUSTAINABLE SOLUTIONS

- High luminous efficacy LEDs for energy savings
- Conscious product design
- Recyclable materials for products and packaging



FEATURES



Multi-mounting Options

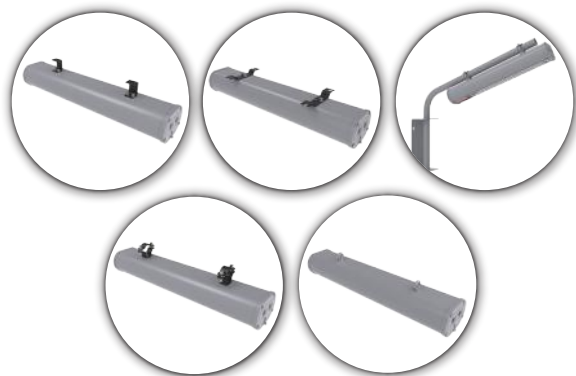

Safe and reliable performance

Offering a T-code of T6(Gas) and T80°C(Dust), much cooler than conventional fixtures, with operating ambient temperature up to 55°C, LED Life L70>470,000 hrs of maintenance-free operation.

Easy and Through Wiring

Built-in WAGO RAIL-MOUNT TERMINAL BLOCKS TOPJOB® S with 4mm² max conductor for easy wiring
Captive screw applied for secure fastening and quick re-installation of wiring compartment
2 cable entries on each end for in-out connection

RATINGS

Zone 1&2
Zone 21&22
IP66
IK10
Salt Spray 720 hrs (ISO 9227)

CERTIFICATIONS

ATEX & UKEX

ROHS

TECHNICAL PARAMETERS

Specification	LLP-20	LLP-40	LLP-50	LLP-60	LLP-80	LLP-100
Electrical Parameters						
Power	20W	40W	50W	60W	80W	100W
Rated Input Current (220V AC)	0.101A	0.202A	0.253A	0.303A	0.404A	0.505A
Voltage/Frequency	120-277V AC 50/60Hz					
Power Factor	≥0.90*					
THD	≤20%					
L70	470,000 hrs@55°C					
Dimming	0-10V, Range 10-100%					
Surge Protection	6KV					
Supply Wire	1mm²-4mm², Rated 90°C					
Warranty	Fixture: 5 Years, Battery: 1 Year					
Optical Parameters						
Lumen Output**	2,208Lm	4,164Lm	5,525Lm	6,448Lm	8,676Lm	10,296Lm
Lumen Output(EM)**	EM6 - 6W (866Lm@180Mins) /EM12 - 12W (1,657Lm@90Mins)					
Lumen Efficacy**	120Lm/W					
Available Beam Angle	110°					
Correlated Color Temperature (CCT)	4000K/5700K/Red/Green/Blue/Amber					
Color Rendering Index (CRI)	Ra>70					
Mechanical Parameters						
Housing Material	Marine Grade Aluminium					
Hardware	Stainless steel 316					
Lens Material	Polycarbonate					
Mounting Options	Low Ceiling, High Ceiling, Wall, Eyebolt, Pole					
Product Weight***	A: 6.3kg/13.89 lbs B: 6.7kg/14.77 lbs	A: 6.3kg/13.89 lbs B: 6.7kg/14.77 lbs C: 9.5kg/20.94 lbs	C: 9.5kg/20.94 lbs D: 9.9kg/21.83 lbs			
Package Weight***	A: 6.3kg/13.89 lbs B: 6.7kg/14.77 lbs	A: 6.3kg/13.89 lbs B: 6.7kg/14.77 lbs C: 9.5kg/20.94 lbs	C: 9.5kg/20.94 lbs D: 9.9kg/21.83 lbs			
Cable Entry	(4) M20/M25					
Product Dimensions (L×W×Hmm)***	A: 747×158×111 B: 864×158×111	A: 747×158×111 B: 864×158×111 C: 1332×158×111	C: 1332×158×111 D: 1449×158×111			
Package Dimensions (L×W×Hmm)***	A: 809×220×170 B: 920×220×170	A: 809×220×170 B: 920×220×170 C: 1388×220×170	C: 1388×220×170 D: 1505×220×170			
Environmental Parameters						
Ambient Operating Temperature	-40°C~+55°C, -20°C~+50°C(Emergency)					
T-Code Rating	T6(Gas Environment) T80°C(Dust Environment)			T5(Gas Environment) T80°C(Dust Environment)		
EPA wind rating (FT2/m2)	A: 1.528/0.142, B: 1.765/0.164, C: 2.722/0.253, D: 2.959/0.275					

* Only the PF value of LLP-20-120-277*-EM is ≥0.8

** Value calculated based on 5700K and Clear PC ,varies to different spec.

***A: Single Lens / Single Access
B: Single Lens / Dual Access
C: Dual Lens / Single Access
D: Dual Lens / Dual Access

ORDERING INFORMATION

EXAMPLE: LLP-60-120-277-57K-X1-CP-1A-EM12-M20

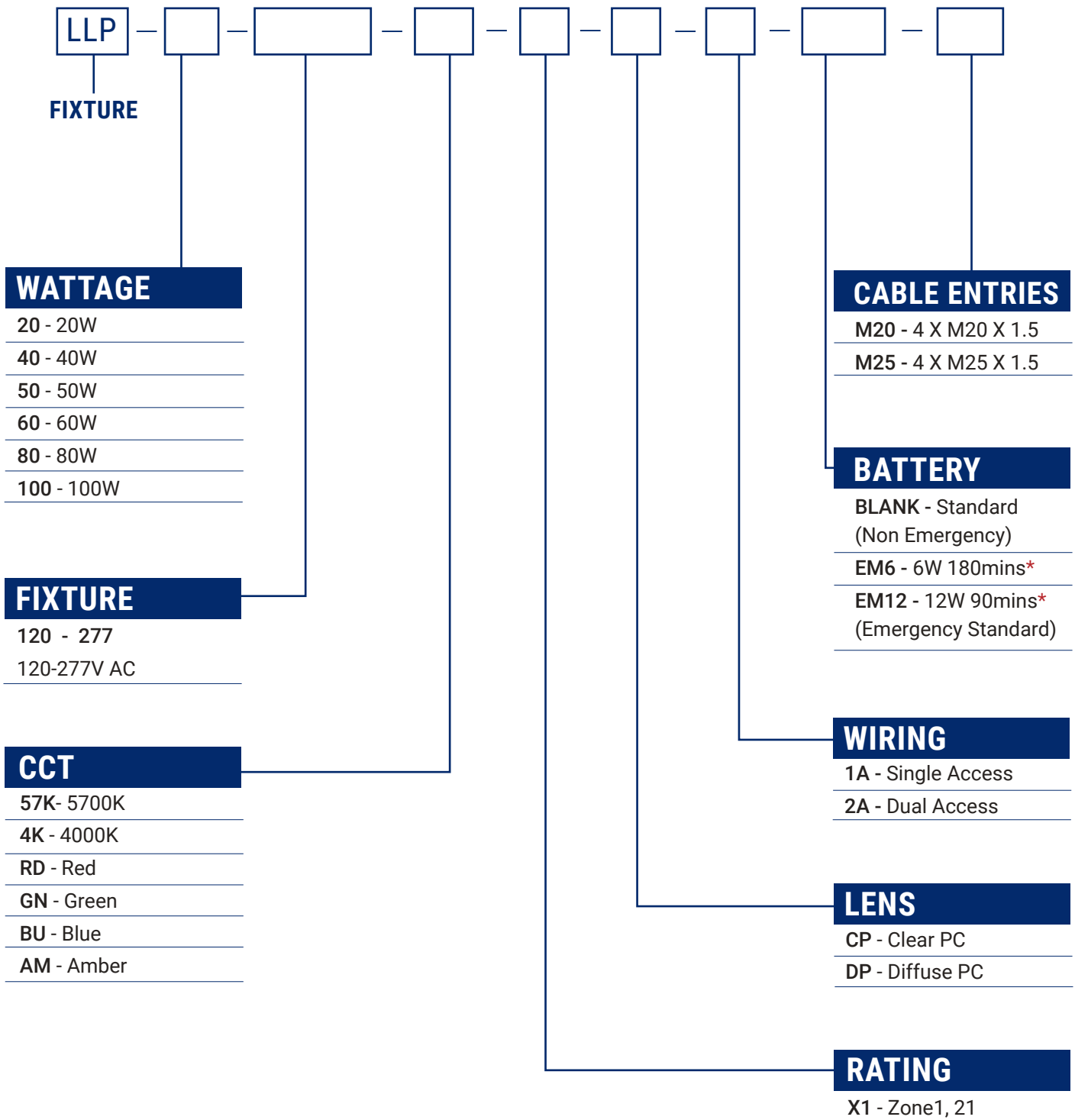

* Emergency only applies to A and C models only, see page 9.

MOUNTING ACCESSORIES

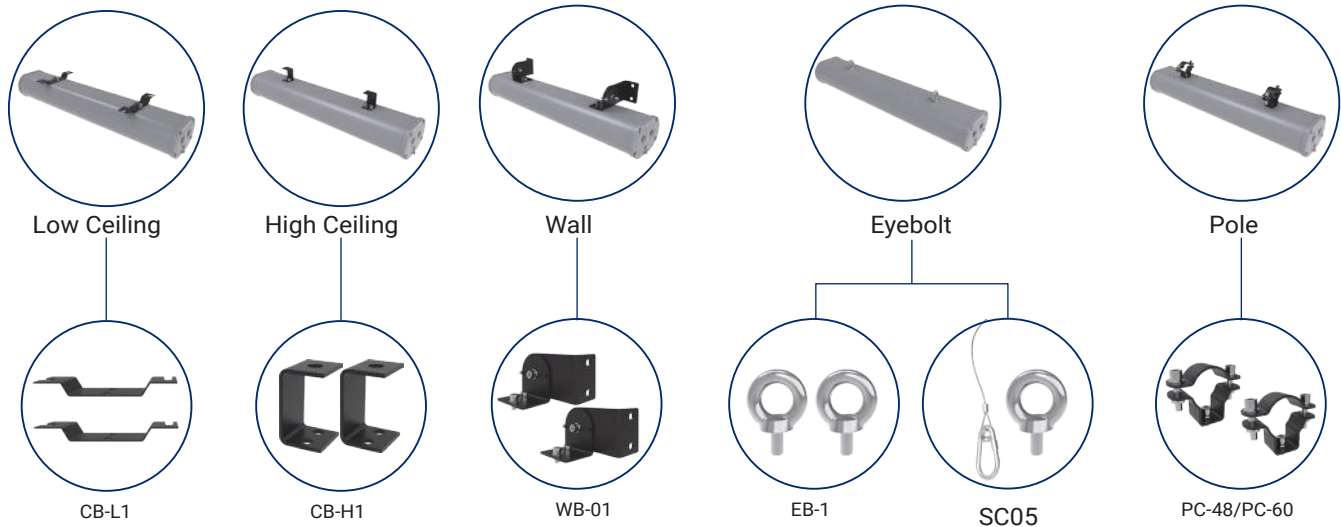

Mounting Method	PN	Description	MPN Code
Low Ceiling	CB-L1	Low Ceiling Mount Bracket, 1 Pair	309050220
High Ceiling	CB-H1	High Ceiling Mount Bracket, 1 Pair	309050222
Wall	WB-01	Wall Mount Swivel Bracket, 1 Pair	309050224
Eyebolt	EB-1	Eyebolt, 1 Pair	309050226
	SC05	Safety Cable Kit, SUS304	309050228
Pole	PC-48	40-51 mm Diameter Range SUS316 Pole Clamp, 1 Pair	309050230
	PC-60	54-62 mm Diameter Range SUS316 Pole Clamp, 1 Pair	309050232

REPLACEMENT PARTS (ORDERED SEPARATELY)

Part Number	Description	MPN Code
LLP-20-Driver	Replacement Driver Kit for LLP-20 Fixtures	303010089
LLP-40-Driver	Replacement Driver Kit for LLP-40 Fixtures	303010090
LLP-50-Driver	Replacement Driver Kit for LLP-50 Fixtures	303010091
LLP-60-Driver	Replacement Driver Kit for LLP-60 Fixtures	303010092
LLP-80-Driver	Replacement Driver Kit for LLP-80 Fixtures	303010093
LLP-100-Driver	Replacement Driver Kit for LLP-100 Fixtures	303010094
LLP-*-EM-Driver	Replacement Driver Kit for LLP-*-EM Fixtures	303010095
LLP-*-EM Battery	Replacement Battery for LLP-*-EM	303040003
CP004-A-01	Replacement Clear PC Lens for LNR2, LNR EM, LLP, LNH	303030012
DP004-A-01	Replacement Diffuse PC Lens for LNR2, LNR EM, LLP, LNH	303030013

LUMEN TABLE

Part Number	Wattage (W)	CCT	Lens	Lumen Output (Lm)	Efficiency (Lm/W)
Voltage 120-277V AC					
LLP-20-120-277-57K-X1-CP-1A-M20	20	5700K	Clear PC	2,208	105
LLP-20-120-277-57K-X1-DP-1A-M20	20	5700K	Diffuse PC	1,805	89
LLP-40-120-277-57K-X1-CP-1A-M20	40	5700K	Clear PC	4,164	104
LLP-40-120-277-57K-X1-DP-1A-M20	40	5700K	Diffuse PC	3,426	86
LLP-50-120-277-57K-X1-CP-1A-M20	50	5700K	Clear PC	5,525	115
LLP-50-120-277-57K-X1-DP-1A-M20	50	5700K	Diffuse PC	4,792	99
LLP-60-120-277-57K-X1-CP-1A-M20	60	5700K	Clear PC	6,448	112
LLP-60-120-277-57K-X1-DP-1A-M20	60	5700K	Diffuse PC	5,513	91
LLP-80-120-277-57K-X1-CP-1A-M20	80	5700K	Clear PC	8,676	110
LLP-80-120-277-57K-X1-DP-1A-M20	80	5700K	Diffuse PC	7,254	93
LLP-100-120-277-57K-X1-CP-1A-M20	100	5700K	Clear PC	10,296	96
LLP-100-120-277-57K-X1-DP-1A-M20	100	5700K	Diffuse PC	9,043	91

For additional information, please contact your sales representative.

A DIRECT RETROFIT FROM HID TO LED

The LLP series LED is easy to retrofit in the same configuration as your existing HID luminaires. For example, a 100-watt Low Profile Linear (LLP-100) delivers virtually the same illumination as its equivalent 200 watt MH luminaire while providing 50% reduction in energy costs and up to 150,000 hours of continuous operation.







MODELS	Lumen Output (Lm)	MH Equivalent (W)	HPS Equivalent (W)
LLP-20	2,208	70	100
LLP-40	4,164	100	150
LLP-50	6,067	150	150
LLP-60	6,448	150	200
LLP-80	7,943	200	225
LLP-100	9,399	200	250

THE RIGHT BEAM PATTERN FOR YOUR APPLICATION

RSL optic package is engineered to deliver maximum footcandles efficiently where you need them, without wasted light or overspill.

RSL offers complimentary lighting design services for our products using industry-leading AGI32 software, tailored for projects of all sizes in harsh and hazardous locations. We assist you in determining the number of fixtures needed, the types of lights to use, their optimal placement, and how to maximize energy savings—all within budget.

Simply fill out the form (<https://dev.redskylighting.com/lighting-design>) with a few key details, request a layout, and we'll bring your ideas to life within 2-5 business days.

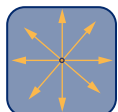
Beam	NEMA/IESNA Type	Beam Description	Beam Projection Distance
30°	NEMA 3	Medium Narrow	
60°	NEMA 4	Medium	
90°	NEMA 5	Medium Wide	
120°	NEMA 6	Wide	
T1	Type I	Asymmetric distributions, well suited for narrow areas, such as Conveyor belts, Aisleways, Catwalks, Loading docks and Tunnels.	
T2	Type II	Asymmetric distributions, well suited for narrow areas, such as roadways, paths and driveways.	
T3	Type III	Asymmetric distributions, well suited for site / area perimeters, wide roadways, and open areas.	
T5	NEMA 7 Type V (Square)	Very Wide: symmetrical pattern with excellent uniformity for large, open areas.	

PHOTOMETRIC

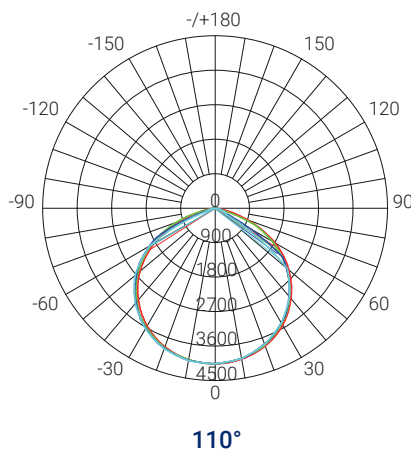

DIMENSIONS

unit: in(mm)

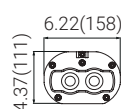
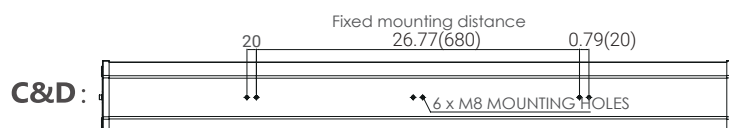
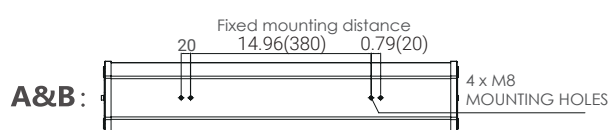
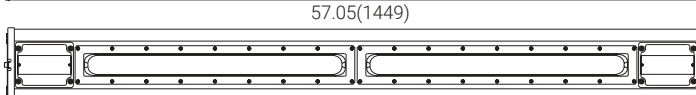
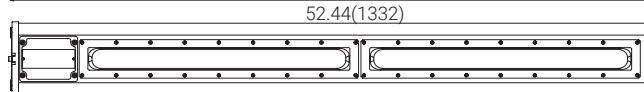
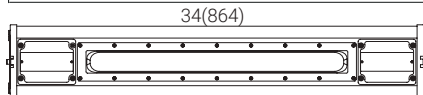

A:	Single Lens / Single Access*	LLP-20/40
B:	Single Lens / Dual Access	LLP-20/40
C:	Dual Lens / Single Access*	LLP-40/50/60/80/100
D:	Dual Lens / Dual Access	LLP-50/60/80/100

* Emergency only applies to A or C models

THROUGH WIRING

In-out connection can be made on one or both sides for quick installation

On both ends of the connection

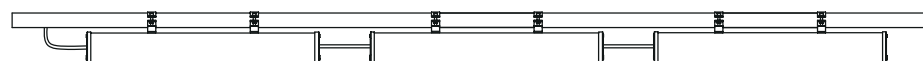

Dual Access

On end of the wire

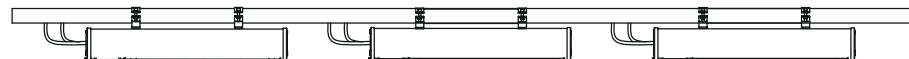

Single Access

unit: in(mm)

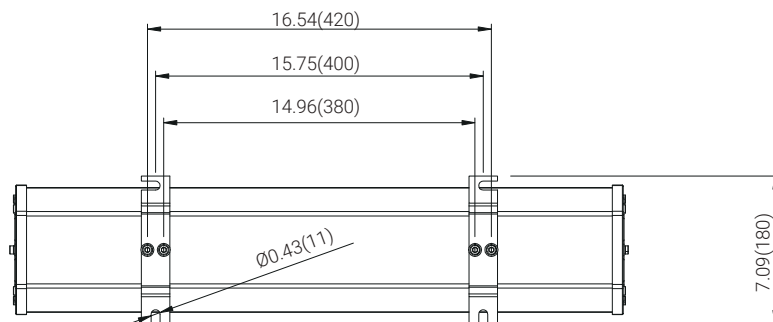

Low Ceiling

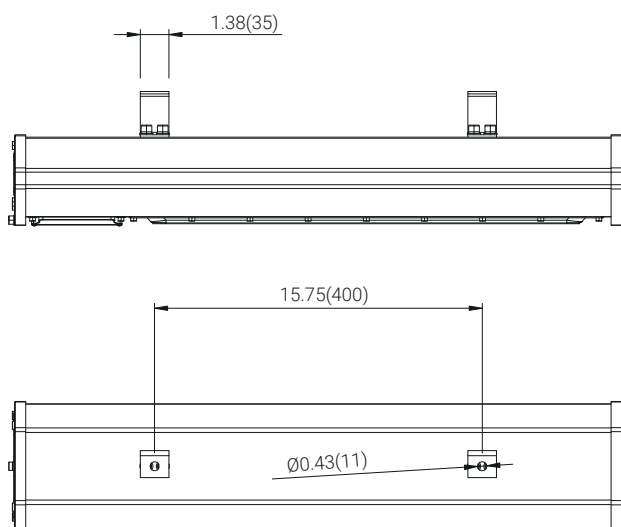
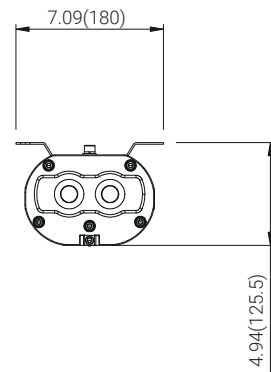

High Ceiling

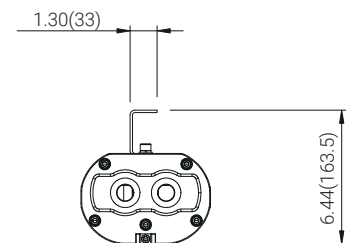

unit: in(mm)

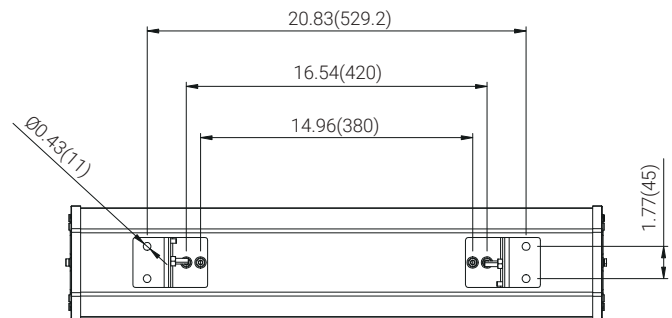
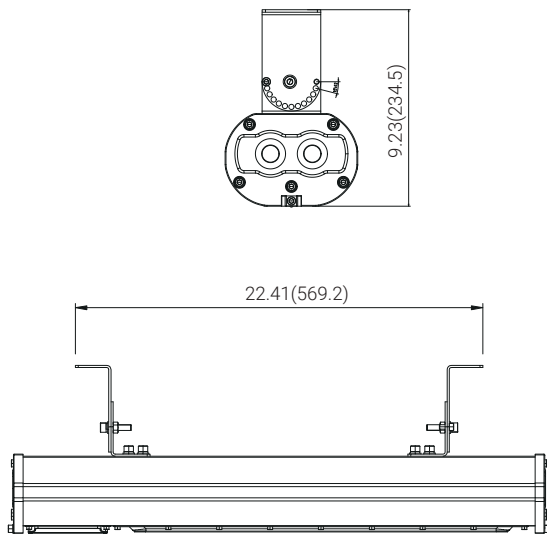

Wall

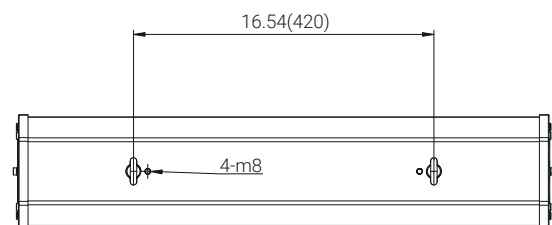
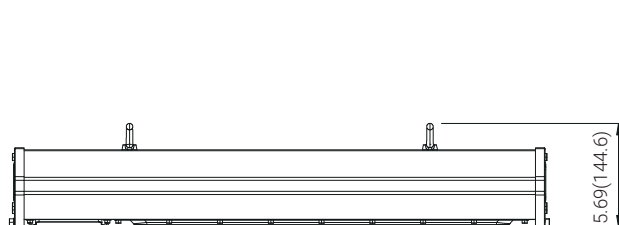

Eyebolt

unit: in(mm)

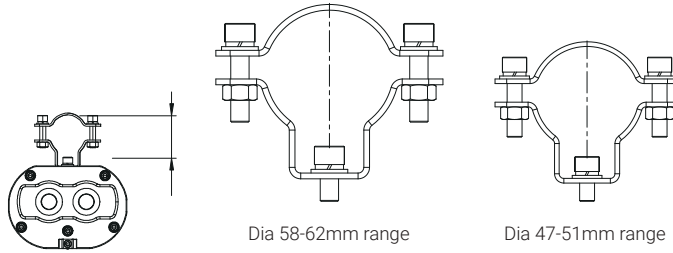
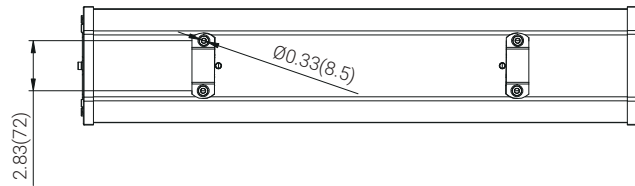

Pole

HAZARDOUS LOCATION LIGHTING BASICS

Atmosphere Groups

Substance	Hazard Class	Division Groups	Zone Groups
Acetylene	Class I Flammable Gases	Group A	IIC
Hydrogen		Group B	IIC
Ethylene		Group C	IIB
Propane		Group D	IIA
Methane		Group D	IIA ²
Combustible Metal Dusts	Class II Combustible Dusts	Group E ¹	IIIC ³
Combustible Carbonaceous Dust		Group F	IIIB ³
Combustible Dusts not in Group E or F (Flour, Grain, Wood, Plastics, Chemicals)		Group G	IIIB ³
Combustible Fibers and Flyings	Class III Fibers and Flyings	Not Applicable	IIIA ³

Note 1: Group E is applicable to Class II, Division 1 only.
 Note 2: Methane is a Group IIA Gas for non-mining applications.
 Note 3: Group IIIA, IIIB and IIIC have not been adopted by the Canadian Electrical Code.

Temperature Classification

Max. Surface Temperatures	NEC®500 CEC®	NEC®500/IEC- Group II
450°C(842°F)	T1	T1
300°C(572°F)	T2	
280°C(536°F)	T2A	T2
260°C(500°F)	T2B	
230°C(446°F)	T2C	
215°C(419°F)	T2D	
200°C(392°F)	T3	T3
180°C(256°F)	T3A	
165°C(329°F)	T3B	
160°C(320°F)	T3C	
135°C(275°F)	T4	T4
120°C(248°F)	T4A	
100°C(212°F)	T5	T5
85°C(185°F)	T6	T6

Classification of Divisions and Zones

Hazard Level	Division Scheme	Zone Scheme	Definitions
Continuous Hazard	Division 1	Zone 0 / Zone 20	A place in which an explosive atmosphere is continually present
Intermittent Hazard		Zone 1 / Zone 21	A place in which an explosive atmosphere is likely to occur in normal operation
Hazard Under Abnormal Conditions	Division 2	Zone 2 / Zone 22	A place in which an explosive atmosphere is not likely to occur in normal operation, but may occur for short periods

IP Codes

1st No.	Solid Objects
0	No protection
1	Objects greater than 50mm
2	Objects greater than 12.5mm
3	Objects greater than 2.5mm
4	Objects greater than 1mm
5	Dust protected
6	Dust proof
2nd No.	Liquids
0	No protection
1	Vertically dripping
2	Dripping up to 15°
3	Limited spraying
4	Splashing from all directions
5	Hosing jets from all directions
6	Strong hosing jets from all directions
7	Temporary immersion
8	Continuous immersion
9	Steam-jet cleaning

IK Ratings

IK Code	Level of Protection Achieved
IK00	Not protected
IK01	Protected against 0.14 joules impact
IK02	Protected against 0.2 joules impact
IK03	Protected against 0.35 joules impact
IK04	Protected against 0.5 joules impact
IK05	Protected against 0.7 joules impact
IK06	Protected against 1 joules impact
IK07	Protected against 2 joules impact
IK08	Protected against 5 joules impact
IK09	Protected against 10 joules impact
IK10	Protected against 20 joules impact

RED SKY LIGHTING LLC
9370 Pittsburgh Ave
Rancho Cucamonga, CA 91730, USA

1(262) 456-5002
contact@redskylighting.com
www.redskylighting.com

RED SKY
SERIOUSLY SAFE LIGHTS™

Rev.02 07/25