

LINEAR TUFF EMERGENCY SERIES

LED LIGHTING FOR HARSH AND HAZARDOUS AREAS



Reliable. Durable. Efficient.
10,000 (854) lumen models

RED SKY
SERIOUSLY SAFE LIGHTS™

ABOUT RED SKY LIGHTING

PIONEERING INDUSTRIAL ILLUMINATION FOR HARSH & HAZARDOUS CONDITIONS

- A leading manufacturer of premium LED lights for demanding work conditions
- Headquartered in California, products assembled in the USA
- Servicing global clients across 4 continents in metal processing, oil & gas, marine, manufacturing
- Renowned for quality, dependability, client care and uncompromising safety standards

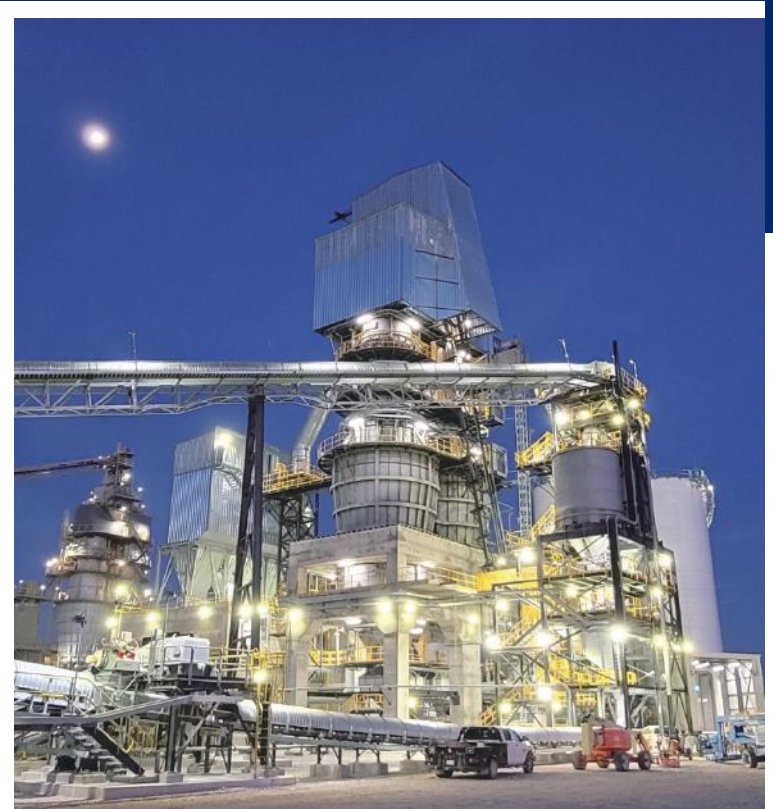

WHY CHOOSE RED SKY

❧ SERIOUSLY SAFE LIGHTS

- Rigorously tested in our professional labs
- Surpassing industry certifications and safety protocols
- Crafted with highest grade components for maximum durability

❧ TOP-NOTCH SERVICES

- Team of experts for seamless support
- Energy audit services, lighting simulation services
- Hassle-free return policy and management

❧ FAST DELIVERY

- Majority of orders delivered within 14 days
- Same day shipping for products in stock
- Real-time order tracking for full transparency

❧ SUSTAINABLE SOLUTIONS

- High luminous efficacy LEDs for energy savings
- Conscious product design
- Recyclable materials for products and packaging

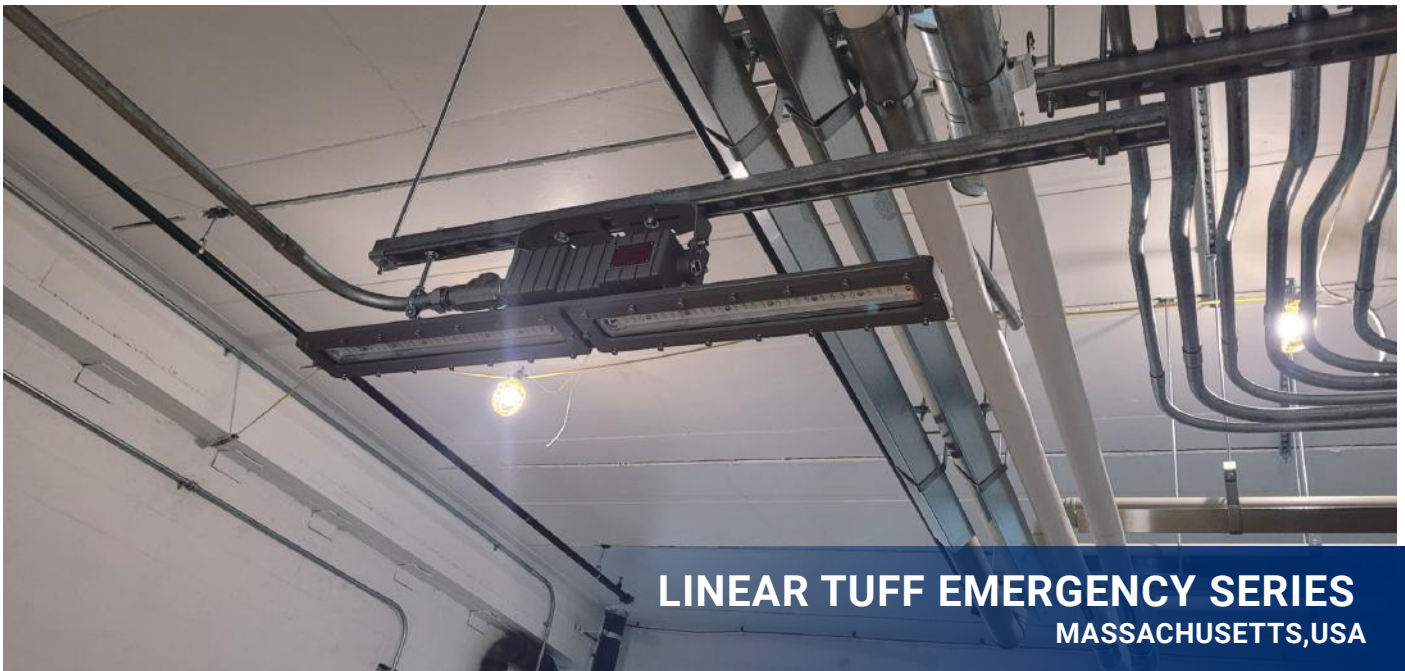

LINEAR TUFF EMERGENCY SERIES

MASSACHUSETTS, USA

FEATURES

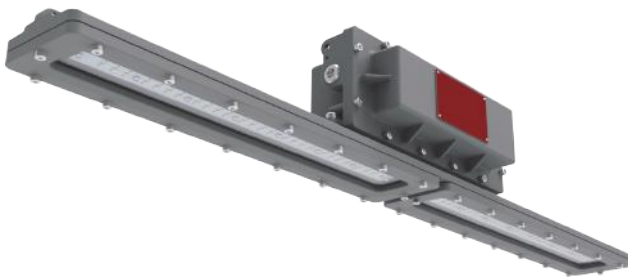

- ❧ Best-in-class system efficacy-Up to 136Lm/W
- ❧ Charge time 24h, Discharge time 1.5h
- ❧ Instant on/off operation
- ❧ Wide ambient temp. range from - 20°C to +45 °C (-4°F ~ +113°F)
- ❧ Safe and reliable heat transfer - Offering a T-rating of T6 (CID1)
- ❧ Shock-and vibration-resistant - Durable LEDs with solder-less board connection
- ❧ All exposed fasteners with quality stainless steel 316
- ❧ Thermal shock and impact resistant tempered glass
- ❧ Slim and compact design

RATINGS

Class I, Division 1, Groups C and D
Class I, Zone 1, Group IIB
IP66
IK07
Salt Spray 720 hrs (ISO 9227)

CERTIFICATIONS

UL 844
CSA C22.2 No. 137
CSA C22.2 No. 30
UL 924
CSA C22.2 No. 141-15
FCC Part 15, Subpart B

TECHNICAL PARAMETERS

Specification	LNT-EM-80
Electrical Parameters	
Power	80W
Rated Input Current	0.741A@120VAC, 0.321A@277VAC
Voltage/Frequency	120-277V AC 50/60Hz
Power Factor	≥0.90
THD	<20%
L70	480,000 hrs@113°F
Dimming	0-10V,Range 10-100%
Supply Wire	12-18AWG, Rated 90°C
Charge Time	24 hours
Emergency Run Time	90mins
Battery	Nickel-Cadmium
Warranty	LEDs:10 Years, Driver:7 Years, Battery:5 Years
Optical Parameters	
Lumen Output*	10,057Lm
Lumen Output (EM)*	854Lm
Lumen Efficacy*	136Lm/w
Available Beam Angle	60° / 110° / T2
Correlated Color Temperature (CCT)	3000K/4000K/5000K
Color Rendering Index (CRI)	Ra>70
Mechanical Parameters	
Housing Material	Marine Grade Aluminium
Hardware	Stainless steel 316
Lens Material	Tempered glass
Mounting Options	Pendant, Yoke, Chain, Pole
Product Weight	26.9lbs/12.2kg
Package Weight	29lbs/13.3kg
Cable Entry	(3) 3/4" NPT
Product Dimensions(L×W×H)	43.3×5.8×7.3in(1100×148×185 mm)
Package Dimensions(L×W×H)	47.1×7.9×10.1in(1197×200×256 mm)
Environmental Parameters	
Ambient Operating Temperature	-4°F~+113°F(-20°C~+45°C)
T-Code Rating	C1D1-T6
Ambient Operating Humidity	10%~90% RH
EPA wind rating (FT2/m2)	2.616/0.243

* Value calculated based on 5000K and Clear glass ,varies to different spec.

ORDERING INFORMATION

EXAMPLE: LNT-80-120-277-5K-110-H1-CG-GRY-PND-EM

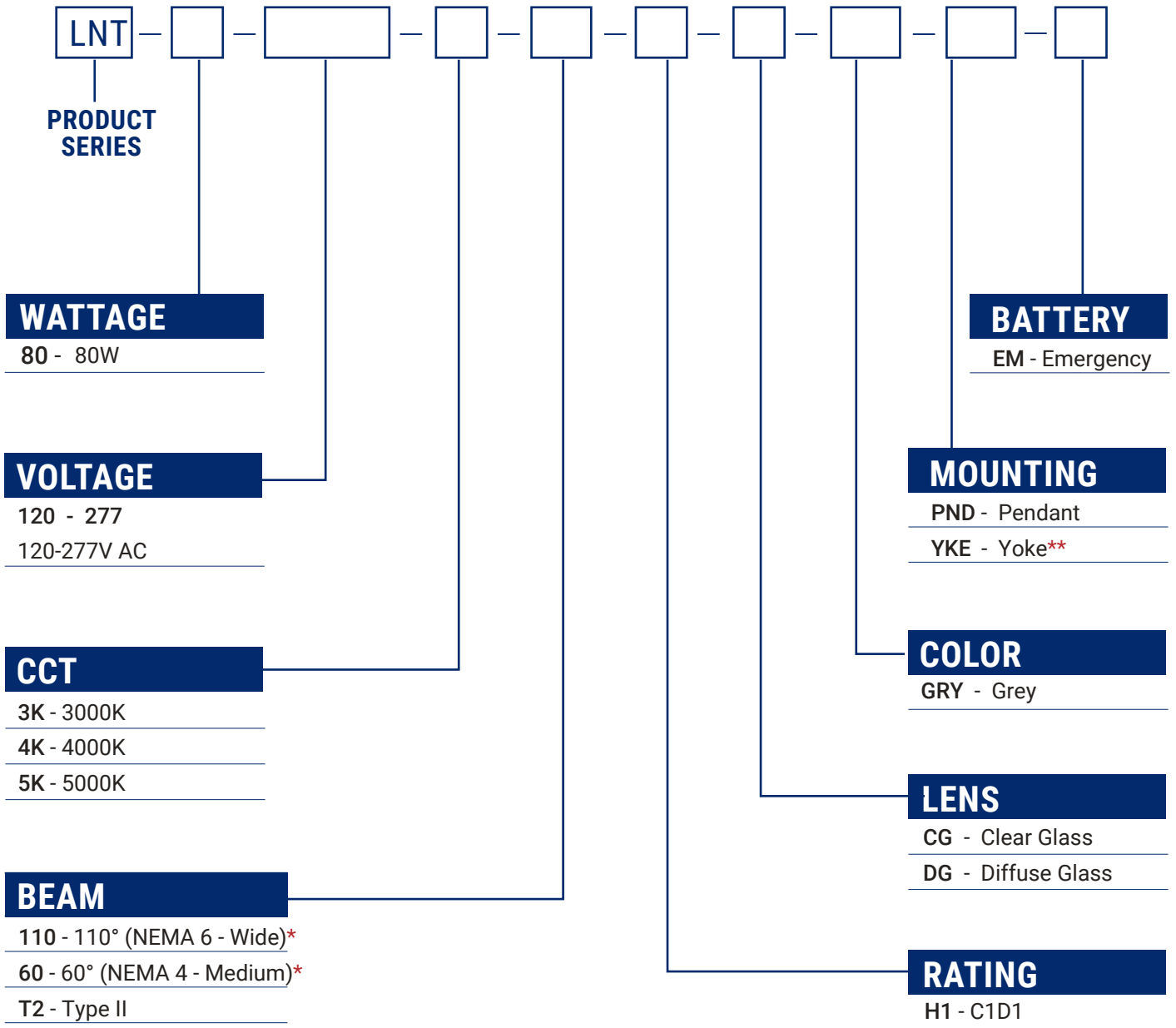

* Only available with Clear Glass Option

** LNT-YOKE Pre-installed as standard

MOUNTING ACCESSORIES

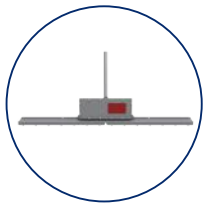

Pendant

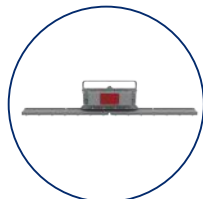

Yoke

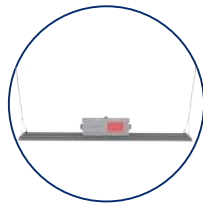

Chain

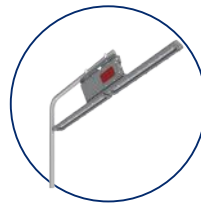

Pole



LNT-YOKE

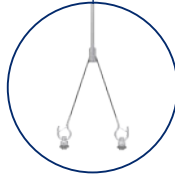

CHAIN01



CLAMP01/02

Mounting Method	PN	Description	MPN Code
Yoke	LNT-YOKE	YOKE Mount, LNT SERIES, SS304, Power Coated Grey RAL7037	309050067
Chain	CHAIN01	CHAIN HANG KIT, LNR&LNT SERIES, SS304	309050071
Pole	CLAMP01	Pipe Clamp Kit for Round pole Φ 1 7/8(48mm), SS304	309050047
	CLAMP02	Pipe Clamp Kit for Round pole Φ 2 3/8(60mm), SS304	309050046

OTHER ACCESSORIES



SFCB02

PN	Description	MPN Code
SFCB02	Safety Cable Kit, RND &BLM&LNT&LNT EM SERIES, SS304	309050058
SP1	10KV Surge Protector 120~277V	309050060

LUMEN TABLE

PN	Wattage (W)	CCT	Beam	Lens	Lumen Output (Lm)	Efficiency (Lm/W)
Voltage 120-277V AC						
LNT-80-120-277-5K-60-H1-CG-GRY-PND-EM	80	5000K	60	Clear Glass	10,457	128
LNT-80-120-277-5K-T2-H1-CG-GRY-PND-EM	80	5000K	T2	Clear Glass	9,555	118
LNT-80-120-277-5K-110-H1-CG-GRY-PND-EM	80	5000K	110	Clear Glass	10,057	123
LNT-80-120-277-5K-110-H1-DG-GRY-PND-EM	80	5000K	110	Diffuse Glass	8,035	99
Emergency Mode						
LNT-80-120-277-5K-60-H1-CG-GRY-PND-EM	6	5000K	60	Clear Glass	824	138
LNT-80-120-277-5K-T2-H1-CG-GRY-PND-EM	6	5000K	T2	Clear Glass	854	143
LNT-80-120-277-5K-110-H1-CG-GRY-PND-EM	6	5000K	110	Clear Glass	812	136
LNT-80-120-277-5K-110-H1-DG-GRY-PND-EM	6	5000K	110	Diffuse Glass	675	113

For additional information, please contact your sales representative.

REPLACEMENT PARTS (ORDERED SEPARATELY)

Part Number	Description	MPN Code
LNT-80-100-277-Driver	Replacement Driver Kit for LNT-80-120-277-EM Fixtures	303010059
LNT-EM Driver	Replacement Emergency Backup Driver Kit (Battery included) for LNT-EM Fixtures	303010108
CG005-A-01	Replacement Clear PC Lens for LNT2, LNT EM	303030014
DG005-A-01	Replacement Diffuse PC Lens for LNT2, LNT EM	303030015

A DIRECT RETROFIT FROM HID TO LED

The LNT EM series LED is easy to retrofit in the same configuration as your existing HID luminaires. For example, a 80-watt Linear Tuff Emergency (LNT-80-EM) delivers virtually the same illumination as its equivalent 250 watt Metal Halide luminaire while providing 80% reduction in energy costs and up to 140,000 hours of continuous operation.







MODELS	Lumen Output (Lm)	MH Equivalent (W)	HPS Equivalent (W)
LNT-80-EM	10,057	250	310

THE RIGHT BEAM PATTERN FOR YOUR APPLICATION

RSL optic package is engineered to deliver maximum footcandles efficiently where you need them, without wasted light or overspill.

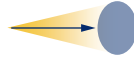
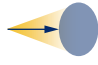
RSL offers complimentary lighting design services for our products using industry-leading AGI32 software, tailored for projects of all sizes in harsh and hazardous locations. We assist you in determining the number of fixtures needed, the types of lights to use, their optimal placement, and how to maximize energy savings—all within budget.

Simply fill out the form (<https://dev.redskylighting.com/lighting-design>) with a few key details, request a layout, and we'll bring your ideas to life within 2-5 business days.

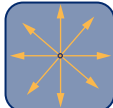
Beam	NEMA/IESNA Type	Beam Description	Beam Projection Distance
30°	NEMA 3	Medium Narrow	
60°	NEMA 4	Medium	
90°	NEMA 5	Medium Wide	
120°	NEMA 6	Wide	
T1	Type I	Asymmetric distributions, well suited for narrow areas, such as Conveyor belts, Aisleways, Catwalks, Loading docks and Tunnels.	
T2	Type II	Asymmetric distributions, well suited for narrow areas, such as roadways, paths and driveways.	
T3	Type III	Asymmetric distributions, well suited for site / area perimeters, wide roadways, and open areas.	
T5	NEMA 7 Type V (Square)	Very Wide: symmetrical pattern with excellent uniformity for large, open areas.	

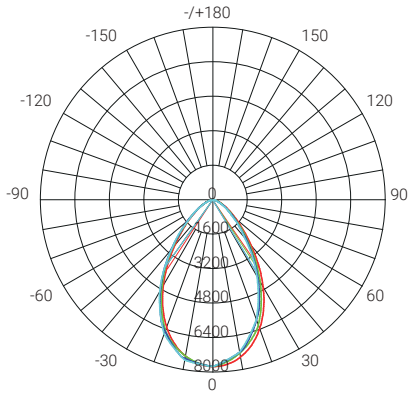

**60°
NEMA 4 - Medium**

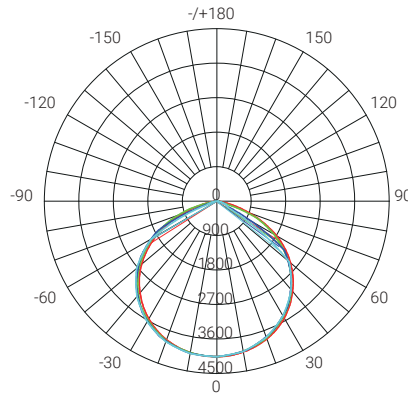

**110°
NEMA 6 - Wide**

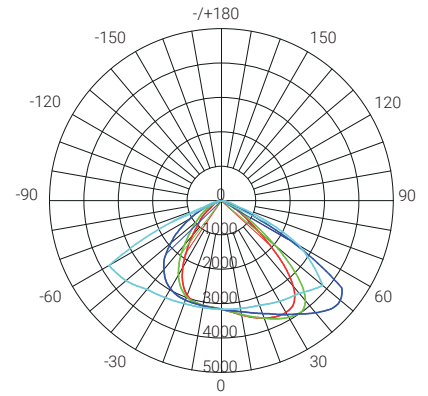

Type II

DIMENSIONS

unit: in(mm)

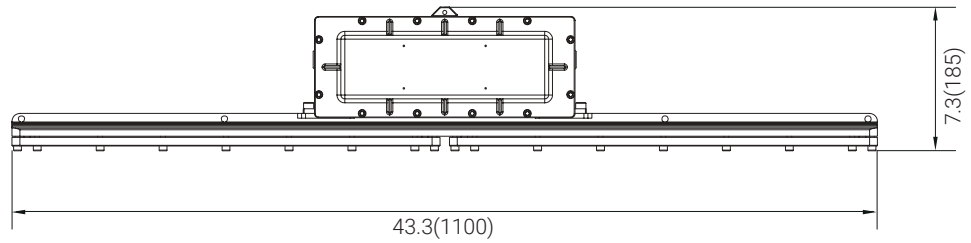
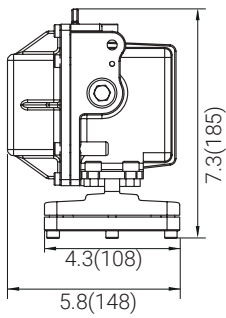

Pendant

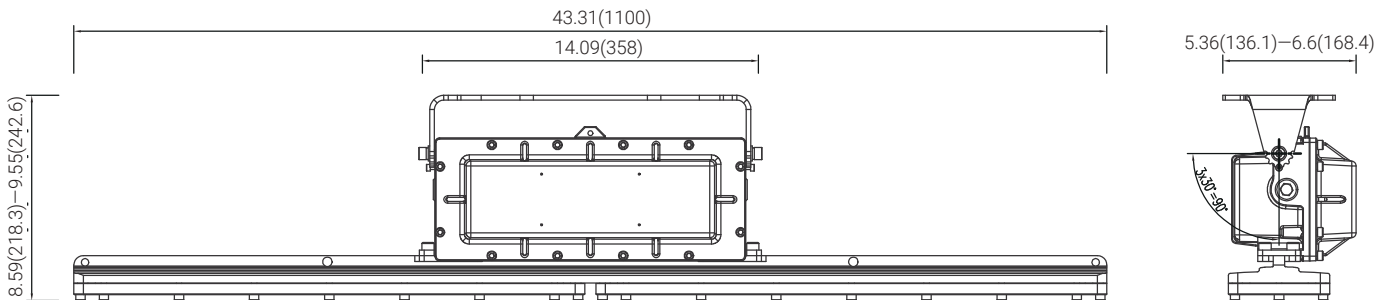

Yoke

unit: in(mm)

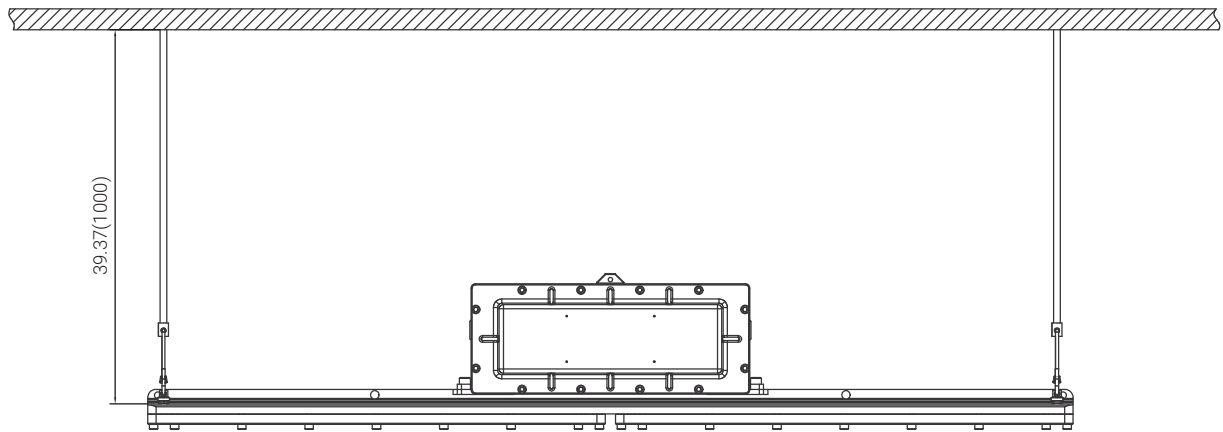

Chain

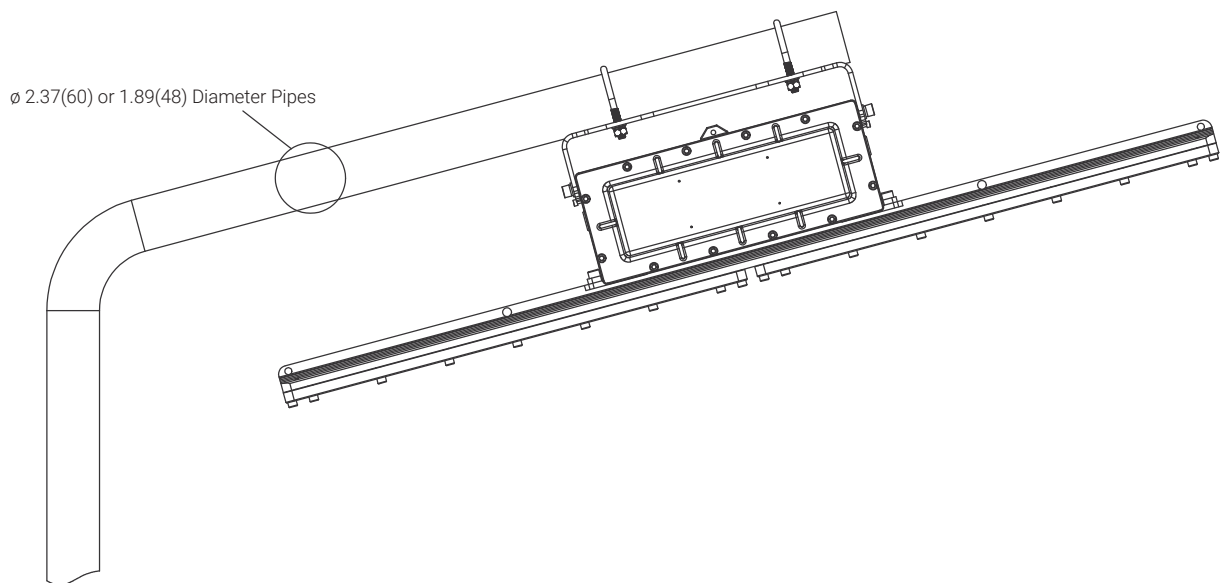

Pole

HAZARDOUS LOCATION LIGHTING BASICS

Atmosphere Groups

Temperature Classification

Substance	Hazard Class	Division Groups	Zone Groups	Max. Surface Temperatures	NEC®500 CEC®	NEC®500/IEC-Group II	
Acetylene	Class I Flammable Gases	Group A	IIC	450°C(842°F)	T1	T1	
Hydrogen		Group B	IIC	300°C(572°F)	T2		
Ethylene		Group C	IIB	280°C(536°F)	T2A	T2	
Propane		Group D	IIA	260°C(500°F)	T2B		
Methane		Group D	IIA ²	230°C(446°F)	T2C		
Combustible Metal Dusts	Class II Combustible Dusts	Group E ¹	IIIC ³	215°C(419°F)	T2D	T3	
Combustible Carbonaceous Dust		Group F	IIIB ³	200°C(392°F)	T3		
Combustible Dusts not in Group E or F (Flour, Grain, Wood, Plastics, Chemicals)		Group G	IIIB ³	180°C(256°F)	T3A	T3	
Combustible Fibers and Flyings		Class III Fibers and Flyings	Not Applicable	IIIA ³	165°C(329°F)		T3B
					160°C(320°F)		T3C
				135°C(275°F)	T4	T4	
				120°C(248°F)	T4A		
				100°C(212°F)	T5	T5	
				85°C(185°F)	T6	T6	

Note 1: Group E is applicable to Class II, Division 1 only.
 Note 2: Methane is a Group IIA Gas for non-mining applications.
 Note 3: Group IIIA, IIIB and IIIC have not been adopted by the Canadian Electrical Code.

Classification of Divisions and Zones

Hazard Level	Division Scheme	Zone Scheme	Definitions
Continuous Hazard	Division 1	Zone 0 / Zone 20	A place in which an explosive atmosphere is continually present
Intermittent Hazard		Zone 1 / Zone 21	A place in which an explosive atmosphere is likely to occur in normal operation
Hazard Under Abnormal Conditions	Division 2	Zone 2 / Zone 22	A place in which an explosive atmosphere is not likely to occur in normal operation, but may occur for short periods

IP Codes

1st No.	Solid Objects
0	No protection
1	Objects greater than 50mm
2	Objects greater than 12.5mm
3	Objects greater than 2.5mm
4	Objects greater than 1mm
5	Dust protected
6	Dust proof
2nd No.	Liquids
0	No protection
1	Vertically dripping
2	Dripping up to 15°
3	Limited spraying
4	Splashing from all directions
5	Hosing jets from all directions
6	Strong hosing jets from all directions
7	Temporary immersion
8	Continuous immersion
9	Steam-jet cleaning

IK Ratings

IK Code	Level of Protection Achieved
IK00	Not protected
IK01	Protected against 0.14 joules impact
IK02	Protected against 0.2 joules impact
IK03	Protected against 0.35 joules impact
IK04	Protected against 0.5 joules impact
IK05	Protected against 0.7 joules impact
IK06	Protected against 1 joules impact
IK07	Protected against 2 joules impact
IK08	Protected against 5 joules impact
IK09	Protected against 10 joules impact
IK10	Protected against 20 joules impact

RED SKY LIGHTING LLC
9370 Pittsburgh Ave
Rancho Cucamonga, CA 91730, USA

1(262) 456-5002
contact@redskylighting.com
www.redskylighting.com

RED SKY
SERIOUSLY SAFE LIGHTS™