

Hazloc LED Luminaire

General Wiring Diagram

CAUTION: Turn off electrical power at fuse or circuit breaker box before wiring fixture to the power supply.

Connecting panels to AC source supply:
All units must be individually connected to the AC supply.

- Brown = Line
- Blue = Neutral
- Kelly = Ground

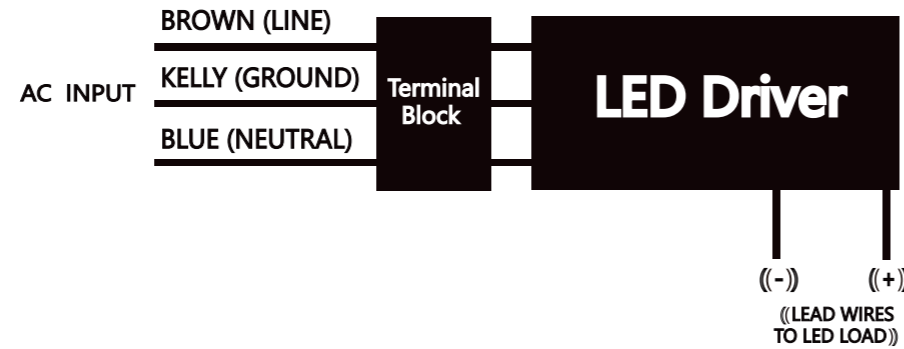

Electrical Connection: (Only permitting metallic conduit systems for wiring methods)

- Loosen the ten M6 hexagon bolts with spring washers and nuts of Tank Cover with torque value 7 N-m.
- The thread of entry hole of Tank is 3/4" NPT. Attach the Tank to suitable conduit.
- Inset the wire from outside through the conduit and the entry hole of Tank, and then connect to Terminal Block.
- Introduce the wires of branch circuit as following:
Brown-wire connects to Line
Blue-wire connects to Neutral
Kelly-wire connects to Ground
- Re-attach the Tank Cover and tight it by ten M6 hexagon bolts with spring washers and nuts with torque value 7 N-m.
- Check the tightness of conduit and Tank Cover.

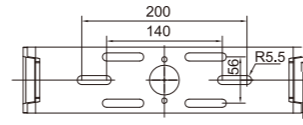

Fig. 1

Ceiling Type:

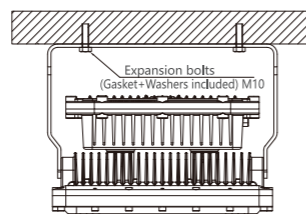
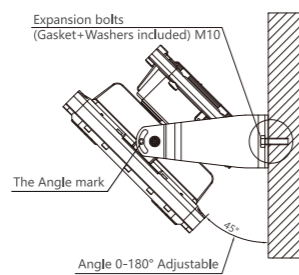

Fig. 2

Wall Type:



Floor Type:

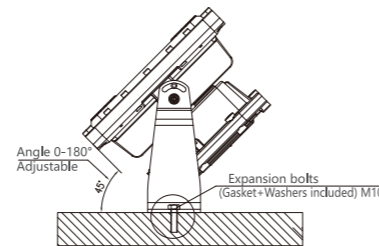
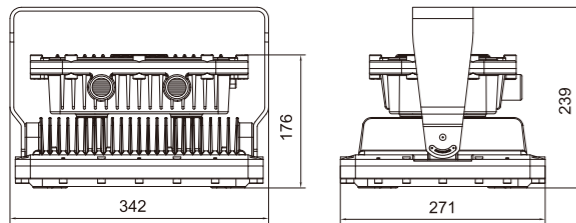

Fig. 3

Wall/Ceiling/Floor Mounting Bracket:

- The mounting bracket is for the use of wall/ceiling/floor mounting.
- Position the mounting bracket and fix it by means of two M6 and two M8 hexagon bolts with spring lock washers.
- Secure the wall/ceiling/floor mounting bracket to the structure by using screws (not provided). (Figure 1)
- The luminaire can be adjusted facing down 90° from vertical = Lens horizontal facing down on ceiling position.(Figure 2)
- The luminaire can be adjusted up and down by 45° on wall/floor position only. (Figure 3)



Hazloc LED Luminaire

Servicing

- To avoid personal injury, disconnect power to the light and allow the unit to cool down before performing maintenance.
- Perform visual, electrical, and mechanical inspections on a regular basis. The environment and frequency of use should determine this. However, it is recommended that checks should be made at least once a year. Frequency of use and environment should determine this.
- The external glass should be cleaned periodically to ensure continued luminaire performance. Clean the glass with a clean, damp, non-abrasive, lint-free cloth. If this is not sufficient, use a mild soap or a liquid cleaner. Do not use an abrasive, strong alkaline or acid cleaner as damage may occur.
- Inspect the cooling fins on the luminaire to ensure that they are free of any contamination (i.e. excessive dust build-up). Clean with a non-abrasive cloth if needed.
- Mechanically check to make sure all parts are properly assembled.
- Electrically check to make sure that all connections are clean and tight.

Housing

- Heavy-duty Anodized Die Casting Aluminum
- Shell surface of electrostatic spraying, Long lasting and Durable
- Shell protection, Over-voltage and Over-heat protection
- Exposed fasteners with quality stainless steel
- Excellent anti-corrosive property

Warranty

We warrants that each of its LED lighting fixtures (the "Product(s)") that are purchased while this Warranty is in effect will be free from defects in materials and workmanship for the period of time specified in the table below (the "Warranty Period"). The Warranty Period runs from the date of original purchase from NJZ or its authorized distributor/dealer.

Effective Date: December 1, 2016

If a Product fails to operate during the Warranty Period as a result of defects in materials or workmanship, NJZ will, at its option, replace it with the same or like Product at no charge or will issue a credit which may be used by the purchaser, within 6 months of issuance, for a NJZ product purchase.

Credit is calculated as follows:

Credit (\$) = Invoiced Purchase Price (\$) x unexpired original Warranty Period (months)/total Warranty Period (months).

LED Product	Which Model Nos. are Covered by this Warranty	Warranty Period
Hazloc LED Luminaire	BLK XXX-XXX-XXX	Five (5) Years

Limitation of Liability

THE FOREGOING WARRANTY IS EXCLUSIVE, AND IS THE SOLE REMEDY FOR ANY AND ALL CLAIMS, WHETHER IN CONTRACT, IN TORT OR OTHERWISE ARISING FROM THE FAILURE OF PRODUCT AND IS IN LIEU OF ALL OTHER WARRANTIES, EXPRESS OR IMPLIED, INCLUDING ALL WARRANTIES OF MERCHANTABILITY OR FITNESS FOR A PARTICULAR PURPOSE, WHICH WARRANTIES ARE HEREBY EXPRESSLY DISCLAIMED TO THE EXTENT PERMITTED BY LAW AND, IN ANY EVENT, SHALL BE LIMITED TO THE WARRANTY PERIOD SPECIFIED ABOVE. THE LIABILITY OF SHALL BE LIMITED TO THE TERMS OF THE EXPRESS WARRANTY SET FORTH HEREIN. IN NO EVENT WILL BE LIABLE FOR ANY SPECIAL, INCIDENTAL OR CONSEQUENTIAL DAMAGES INCLUDING, WITHOUT LIMITATION, DAMAGES RESULTING FROM LOSS OF USE, PROFITS, BUSINESS OR GOODWILL, LABOR COSTS, REMOVAL OR INSTALLATION COSTS, DECREASE IN THE LIGHT OUTPUT OF THE LAMP, AND/OR DETERIORATION IN THE LAMP'S PERFORMANCE, WHETHER OR NOT HAS BEEN ADVISED OF THE POSSIBILITY THEREOF. UNDER NO CIRCUMSTANCES SHALL 'S ENTIRE LIABILITY FOR A DEFECTIVE PRODUCT EXCEED THE PURCHASE PRICE OF THAT PRODUCT. WARRANTY SERVICES PROVIDED UNDER THESE TERMS AND CONDITIONS DO NOT ENSURE THE UNINTERRUPTED OPERATION OF PRODUCTS; SHALL NOT BE LIABLE FOR DAMAGES CAUSED BY ANY DELAYS INVOLVING WARRANTY SERVICE.

This Limited Warranty gives you specific legal rights and you may also have other rights that may vary from state to state. Because some states or jurisdictions do not allow the exclusion or limitation of liability for consequential or incidental damages, this limitation may not apply to you.

For full warranty and Additional Terms and Conditions please see:

<http://www.njzlighting.com>

Hazloc LED Luminaire

NPT Assembly Instructions:

STEP 1: Inspect port and fitting to ensure that both are free of contaminants and excessive burrs and nicks.

STEP 2: Apply a stripe of an anaerobic liquid pipe sealant around the male threads leaving the first two threads uncovered. If no liquid sealant is available, wrap Teflon tape (width of 12.7mm and thickness of 0.1mm) 2.5- 3 turns in a clockwise direction, viewed from the pipe end, leaving the rest two threads uncovered.

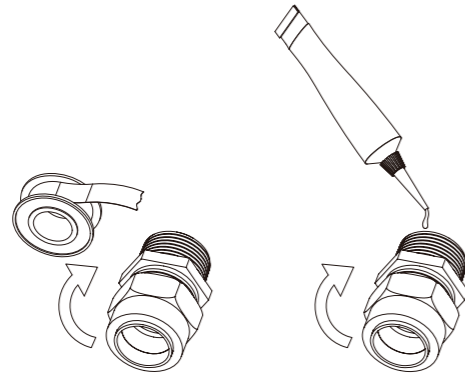

CAUTION: Teflon tape and some pipe sealants are destructive to hydraulic components. Always use extreme caution and follow manufacturer's recommendations for proper application of any sealant in order to prevent contamination.

STEP 3: Screw finger tight into the port

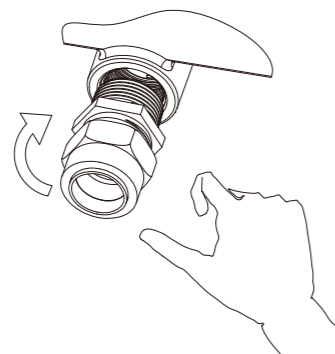

STEP 4: Wrench tighten the fitting to the correct Turns Past Finger Tight position. A properly assembled fittings total thread engagement should be 3.5 to 6 turns.

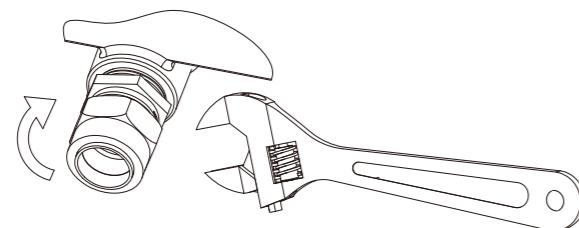

CAUTION: Never back off an installed pipe fitting to achieve proper alignment. Loosening installed pipe fittings will corrupt the seal and contribute to leakage and failure.
(*Applicable standard: ASME B1.20.1-2013)

Hazloc LED Luminaire

General Safety Information

- The explosion proof lighting can be installed in Zone1, Zone2, Zone21, Zone22 area.
- To reduce the risk of death, personal injury or property damage from fire, electric shock, falling parts, cuts/abrasions, and other hazards read all warnings and instructions included with and on the fixture box and all fixture labels.
- Before installing, servicing, or performing routine maintenance upon this equipment, follow these general precautions.
- Commercial installation, service and maintenance of luminaires should be performed by a qualified licensed electrician.
- This fixture is intended to be connected to a properly installed and grounded UL listed junction box.
- **DO NOT INSTALL DAMAGED PRODUCT!**
- Make sure that the supply voltage is the same as the luminaire voltage.
- Do not install where the marked operating temperatures exceed the ignition temperatures of the hazardous atmosphere.
- Do not operate in ambient temperatures above those indicated on the luminaire nameplate.
- All gasket seals must be clean and undamaged.

WARNING:

- Turn off electrical power at fuse or circuit breaker box before wiring fixture to the power supply.
- Turn off the power when you perform any maintenance.
- Verify that supply voltage is correct by comparing it with the luminaire label information.
- Make all electrical and grounded connections in accordance with the National Electrical Code and any applicable local code requirements.
- Luminaire must be supplied by a wiring system with an equipment grounding conductor.
- The flameproof joints are not intended to be repaired.
- Use fasteners with yield stress not less than 450Mpa, A2-70.
- The electrical installation must be installed according to the requirements specified in EN/IEC 60079-14 or national equivalent requirements at the place of installation.

CAUTION:

RISK OF INJURY

- Wear gloves and safety glasses at all times when removing luminaire from carton, installing, servicing or performing maintenance.
- Avoid direct eye exposure to the light source while it is on.
- Account for small parts and destroy packing material, as these may be hazardous to children.

CAUTION:

RISK OF FIRE

- Keep combustible and other materials that can burn away from luminaire and lamp/lens.
- MIN 105°C SUPPLY CONDUCTORS.

Models:

BLK C1-XXX

XXX=Power(080=80W,100=100W,150=150W)

Operating characteristic:

- Rated Voltage: 100-240 Vac , 50/60Hz
- Ambient Temperature Range: -25°C ~ +50 °C



Picture is for illustration purposes only. Your model may vary

This luminaire is suitable for use in the following hazardous (classified) areas as defined by the International Electro technical Commission (IEC):

IECEx:

Ex db IIB T6 Gb

Ex tb IIIC T85°C Db

IECEx UL 17.0099X

Standards

IEC 60598-1: 2008

IEC 60079-0: 2011

IEC 60079-1: 2014

IEC 60079-31: 2013

Environmental Ratings

Suitable for wet location

Refer to the luminaire nameplate for specific classification information, maximum ambient temperature suitability and corresponding operating temperature (T-Code).