

RTR SERIES RETROFIT ADAPTOR

RTR Series Retrofit Adaptor is designed for 1-for-1 retrofit installation and replacement in hazardous and ordinary locations, being able to mount directly to the pre-existing mounting hoods can save a significant amount of labor time, and cost, moreover, ideal retrofit LED solutions allow facilities to utilize existing mounting hoods and conduit/wiring systems, helping to reduce new fixture installation labor costs. Retrofit adaptors are often available, allowing fixtures to mate with a wide range of mounting hoods, letting your facility consolidate with a single luminaire. RTR Series offers higher efficacy for increased energy savings, lower maintenance costs, and shorter paybacks.

SPECIFICATION

DIMENSIONS	:	RTR-CMP: $\varnothing 10.28 \times 1.61 \text{ in} (\varnothing 261 \times 41 \text{ mm})$ RTR-MM3: $\varnothing 12.09 \times 2.36 \text{ in} (\varnothing 307 \times 60 \text{ mm})$ RTR-MM2: $\varnothing 9.69 \times 1.61 \text{ in} (\varnothing 246 \times 41 \text{ mm})$ RTR-KLK: $\varnothing 11.89 \times 1.61 \text{ in} (\varnothing 302 \times 41 \text{ mm})$ RTR-HZL: $\varnothing 11.85 \times 2.68 \text{ in} (\varnothing 301 \times 68 \text{ mm})$ RTR-HLX: $\varnothing 12.6 \times 1.61 \text{ in} (\varnothing 320 \times 38 \text{ mm})$ RTR-GE(L×W×H): $14 \times 8.39 \times 1.77 \text{ in} (356 \times 213 \times 45 \text{ mm})$
MATERIAL	:	Aluminium alloy
WARRANTY	:	Standard: 5-Year

COMPATIBLE PRODUCTS FOR OTHER BRANDS

Item	Description	MPN Code
RTR-CMP	: Eaton's Crouse-Hinds – Champ®	201010116
RTR-MM2	: Appleton® Mercmaster II	201010118
RTR-MM3	: Appleton® Mercmaster III	201010117
RTR-HZL	: Thomas & Betts Hazlux®	201010120
RTR-HLX	: Holophane® Petrolux II, III	201010121



SCAN TO LEARN MORE

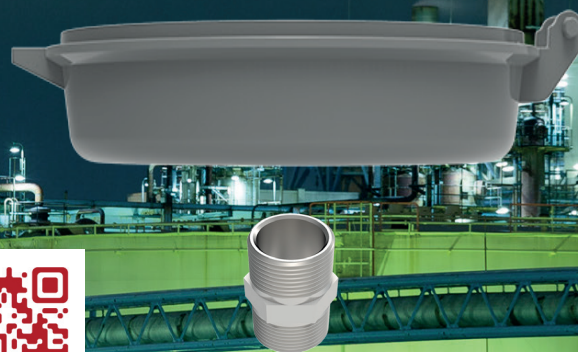

RATINGS & CERTIFICATIONS

NEC/CEC Standard

- > UL514A
- > CSA C22.2#18.1
- > UL844 listings with RDX series
 - > Class I, Division 2, Groups A, B, C, D
 - > Class I, Zone 2 Group IIC
 - > Class II, Division 1, Groups E, F, G
 - > Class II Division 2, Groups F, G
 - > Class III



APPLICATION

Upgrade existing installed top hats to LEDs / Hazardous and Heavy Industrials Storage / Power Plants / Pulp and Paper mills / Wastewater Treatment Plants / Chemical Plants / Petrochemical Facilities

FEATURES

- > Copper-free aluminum housing with polyester powder coat finish in color RAL7037
- > Adaptor with pre-installed silicone gasket
- > One-man operation design for easy, fast installation and replacement
- > Stainless steel 316 external hardware
- > Allow end-users to retrofit energy-efficient LED luminaires to pre-existing mounting hoods of conventional lighting units
- > Utilize existing conduit and wiring systems for massive cost savings on labor and material
- > 5 types available for use with Red Sky Lighting LED Luminaires as well as other brands
- > Adaptor kit can be field installed and sold as an accessory only



RTR-CMP



RTR-MM2



RTR-MM3



RTR-HZL



RTR-HLX

DIMENSIONS

CMP

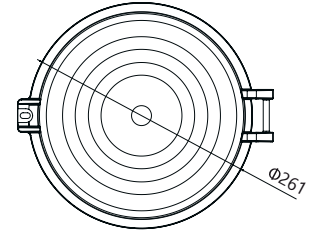
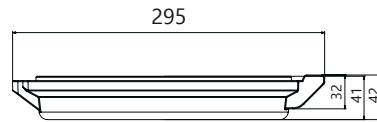
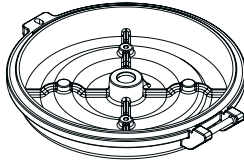

MM2

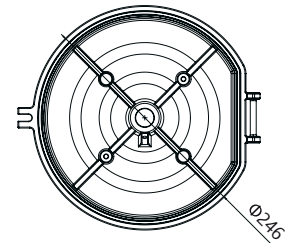
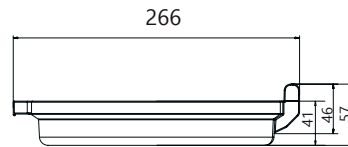
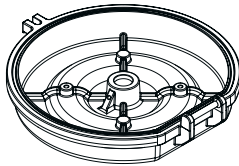

MM3

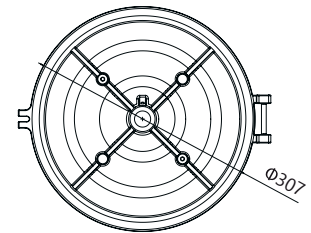
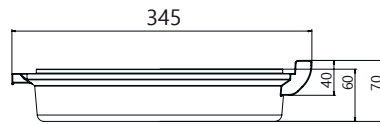
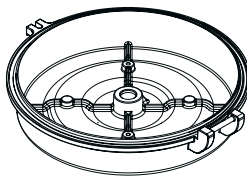

HZL

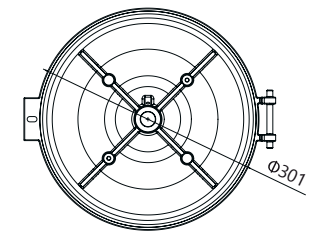
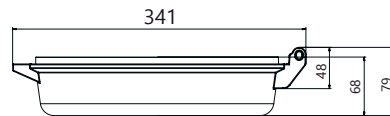
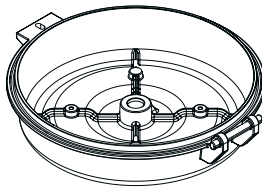

HLX

